



Aprilia RSV 1000 TUONO (2003)

Slip-on Exhaust System

Akrapovic Slip-on Exhaust System

for the Aprilia RSV 1000 TUONO (2003)

The Akrapovic SLIP-ON system represents the first level of serious exhaust system modification. However, despite its being an entry level system, it delivers a surprising increase in power and torque. The naked version of the Mille, the Tuono works really well with the Akrapovic SLIP-ON system in terms of both performance and aesthetics. This is in large part due to the experience we gain with the Aprilia factory team, which we are able to transfer to our production components.

PERFORMANCE

Measurements of the Akrapovic SLIP-ON system on the APRILIA RSV 1000 TUONO:

Power: a huge increase in power is shown from 6800 rpm on. The increase is exceptional for a first-level component, delivering 112.8 HP at 9600 rpm. Up to 6800 rpm the Akrapovic power curve runs opposite to the stock curve, but with this much power this has no effect on the smoothness of the power delivery.

Torque: the huge amount of torque generated by the Aprilia twin can be seen from the torque curve, and our system just builds on it. This is especially evident at the low end of the range, which means comfortable pulling out of low revs, even in higher gears. And at high revs there is also clearly a huge amount of additional torque.

CONFIGURATION

The Akrapovic SLIP-ON system is composed of a cylindrical stainless steel link pipe connected at both ends to the other exhaust components (mufflers, header assembly) with free-floating joints secured by silicon-shielded tensioning springs. All of the interior metal parts of the oval section muffler are made of titanium, as is the outer sleeve. The muffler is attached to the frame with an Akrapovic carbon-fiber clamp.

OPTIONS

The SLIP-ON system for the Aprilia Tuono is also available with a titanium link pipe.

	PERFORMANCE		
	stock	AKRAPOVIC	max. increased power
max. rear wheel power HP / rpm (measured on SuperFlow Cycle Dyn)	106.5 / 9350	112.8 / 9600	8.4 / 10000

	CONFIGURATION		
	header tubes	collector	link pipe
material	-	-	STAINLESS STEEL
tube shape	-	-	CYLINDRICAL

interference crossover tubes	-	lambda sensor	-
header tube inner sleeves	-	header tube flanges	-
header tubes - collector connection	-	collector / link pipe connection	FREE FLOATING + SILICON SHIELDED SPRINGS
link pipe - muffler connection	FREE FLOATING + SILICON SHIELDED SPRINGS	muffler inlet cap / outlet cap	TITANIUM / TITANIUM
muffler metal interior	TITANIUM	muffler outer sleeve	TITANIUM
muffler clamp	1x CARBON-FIBER ROAD	muffler bracket	-
noise damper	-	heat shield	-

OPTIONS				
link pipe	noise damper	muffler outer sleeve	muffler bracket	heat shield
TITANIUM	-	-	-	-

	ADDITIONAL DATA				
	stock	AKRAPOVIC		difference	
		S.S. link pipe	TITANIUM link pipe	stock - S.S.	stock - TI.
weight comparison (kg)	6.95	2.69	2.52	4.26	4.43
noise measurements (dB / rpm)	stock		AKRAPOVIC		
	94 / 4625		98 / 4625		
possibility of periodic service without removing A.E.S.	oil		oil filter		
	YES		YES		
legal for street use	NO				

Technical specifications of Akrapovic exhaust systems and related products subject to change without notice.

Product code: S-A10SO2-T, S-A10SO2T-T

Akrapovic Slip-on Exhaust System

for the Aprilia RSV 1000 TUONO (2003)



Akrapovic Exhaust System Technology copyright 2004, all rights reserved

Road Program

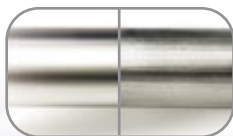

The link pipe is made of stainless steel or titanium (optional)



CARBON-FIBER MUFFLER CLAMP

Product code: S-A10SO2-T, S-A10SO2T-T

Akrapovic Slip-on Exhaust System for the Aprilia RSV 1000 TUONO (2003)



Akrapovic Exhaust System Technology copyright 2004, all rights reserved

Road
Program

Product code: S-A10SO2-T, S-A10SO2T-T

Akrapovic Slip-on Exhaust System for the Aprilia RSV 1000 TUONO (2003)



Akrapovic Exhaust System Technology copyright 2004, all rights reserved

Road Program

Product code: S-A10SO2-T, S-A10SO2T-T

Akrapovic Slip-on Exhaust System

for the Aprilia RSV 1000 TUONO (2003)

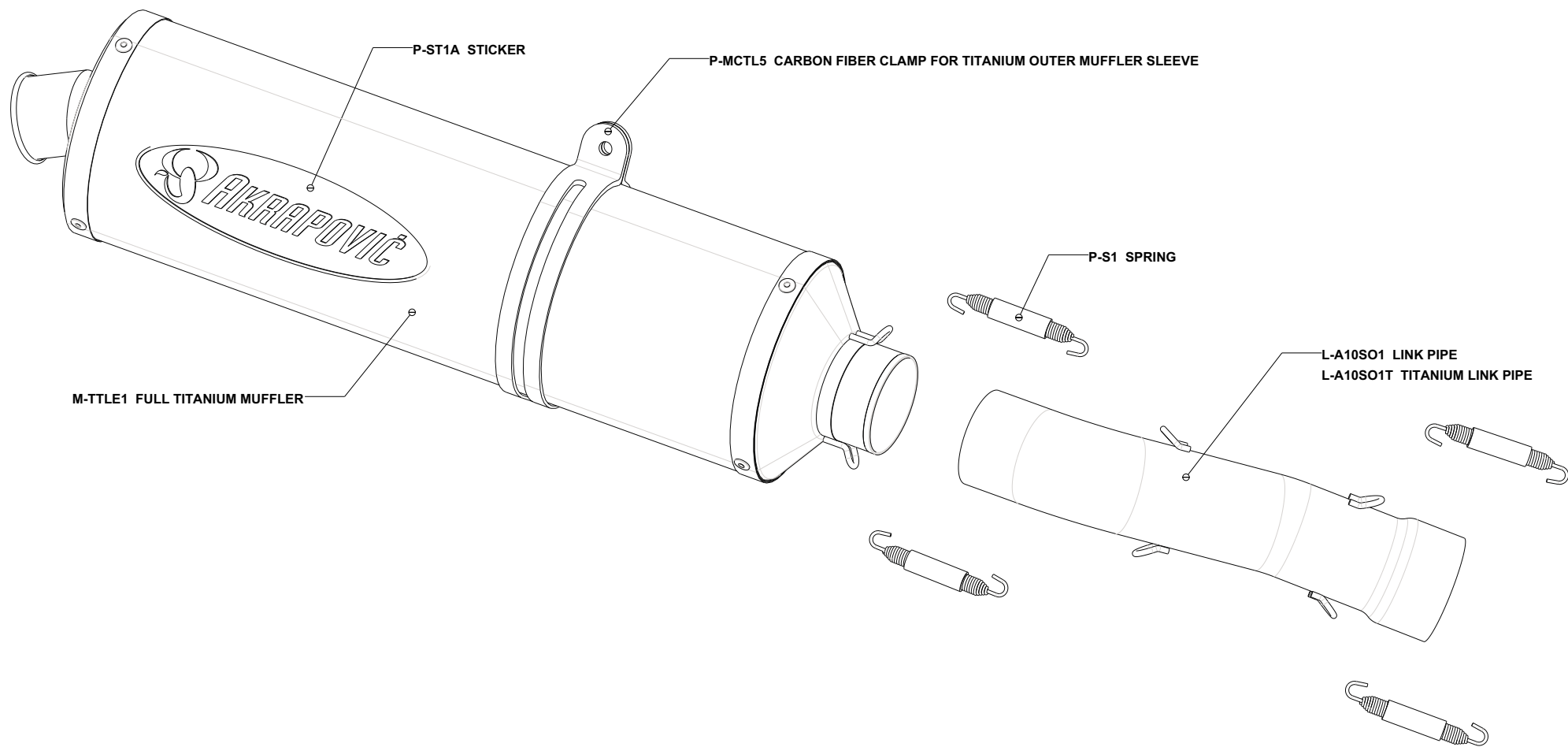

Akrapovic Exhaust System Technology copyright 2004, all rights reserved

Road
Program

Akrapovic Slip-on Exhaust System

for the Aprilia RSV 1000 TUONO (2003)

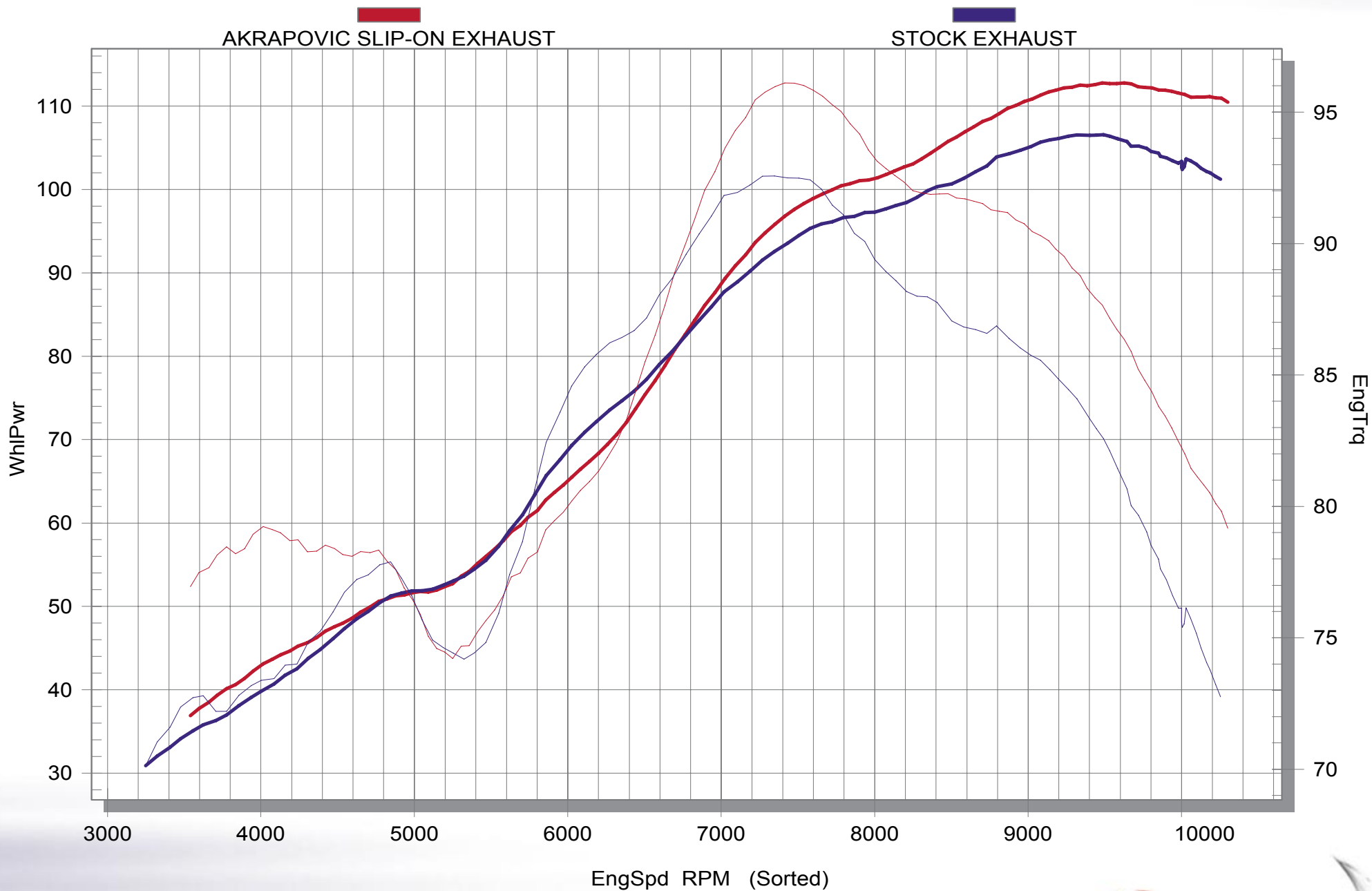

Akrapovic Exhaust System Technology copyright 2004, all rights reserved

Road Program

Product code: S-A10SO2-T, S-A10SO2T-T

