



**AKRAPOVIC RACING & EVOLUTION and  
RACING & EVOLUTION STREET LEGAL EXHAUST SYSTEM  
for the  
BMW F 800 S / ST (2006-2009)**

**Congratulations on purchasing an Akrapovic exhaust system. Please read these installation instructions carefully. If you have any trouble installing the system please contact your authorized dealer!**

**IMPORTANT INFORMATION**

**Exclusion of Certain Liability**

1. The manufacturer, importer or dealer shall not be liable for any incidental damage including personal injury or any other damages caused by improper installation or operation of the Akrapovic exhaust system. When installing the Akrapovic exhaust system be careful that the exhaust system does not touch other parts sensitive to high temperature.
2. Akrapovic makes no representation or warranties with regard to damage caused by the improper installation, use and maintenance of the Akrapovic exhaust system. The warranty is limited to defects recognized by our technical department and to normal use, and excludes items subject to normal wear (gaskets and damping wool). The guarantee is void in case of accident, modification, improper or competition use.
3. Do not attempt to install the Akrapovic exhaust system on a motorcycle for which it was not made or tested by Akrapovic.
4. When the exhaust system gets very hot during operation, be careful not to burn yourself on the exhaust system or parts which are in direct contact with it, even when the motor is not running. Also protect other people, especially children, from the injuries mentioned above.
5. In some cases Akrapovic exhaust system kits contain chemical products (ceramic anti-seizing grease; bolt sealant). Handle with care, do not inhale or swallow. Avoid excessive contact with skin, eyes or mucous membranes. Keep out of reach of children.
6. Technical specifications of Akrapovic exhaust systems and related products subject to change without notice.

**Trademarks**

The Akrapovic Exhaust System Technology logo is a registered trademark of Akrapovic d.d.

**Akrapovic website**

Information about Akrapovic exhaust systems and related products is available on the Akrapovic website at:  
**<http://www.akrapovic.com/>**

**Copyright**

No part of the Akrapovic exhaust system or its documentation may be reproduced or distributed in any form or by any means without the prior written authorization of the Akrapovic company.

© Akrapovic, d.d. All rights reserved.

**Symbols**

The following symbols are used throughout these installation instructions:



## INSTALLATION INSTRUCTIONS

 **BEFORE INSTALLING CHECK SCHEMATIC OF THE EXHAUST SYSTEM!**

 **IF ANY ITEMS IN THE AKRAPOVIC EXHAUST SYSTEM PACKAGE ARE MISSING PLEASE CONTACT YOUR AUTHORIZED DEALER. KEEP THE SCHEMATIC FOR FUTURE REFERENCE.**

 **THESE INSTALLATION INSTRUCTIONS MUST BE READ CAREFULLY IN ORDER TO ENSURE PROPER INSTALLATION AND OPERATION OF THE AKRAPOVIC EXHAUST SYSTEM.**

 **THE EXHAUST SYSTEM CAN BE EXTREMELY HOT. ALLOW THE MOTORCYCLE TO COOL DOWN BEFORE BEGINNING INSTALLATION.**

 **WE ADVISE YOU TO LEAVE INSTALLATION TO A QUALIFIED SERVICEMAN. IMPROPER INSTALLATION MAY RESULT IN A SHORTER LIFETIME OF THE EXHAUST SYSTEM AND/OR DAMAGE TO THE MOTORCYCLE.**

### REMOVAL OF STOCK EXHAUST SYSTEM

1. put the motorcycle on a side / main stand
2. unscrew and remove the bolt from the metal clamp at the muffler/ link pipe - collector joint. Loosen the metal clamp. (Figure 1, 2)
3. unscrew the bolt from the muffler metal clamp and remove the muffler (Figure 3, 4)
4. unscrew the lambda sensor (Figure 5, 6)
5. unscrew the nuts from the header tube flanges and remove the stock header tubes; make sure not to damage the cooling fins (Figure 7, 8, 9)

### INSTALLATION OF THE AKRAPOVIC RACING OR EVOLUTION EXHAUST SYSTEM

#### **installing the header tubes:**

1. set up the sleeves together with the flanges and springs; make sure they are correctly oriented and that the holes for attaching the springs line up with the loops on the header tubes; tighten the flanges – use stock nuts; make sure not to damage the cooling fins (Figure 10, 11, 12)
2. insert the header tubes properly and attach the springs; make sure not to damage the cooling fins (Figure 13, 14, 15)
3. make sure the header tubes are not touching the engine, other tubes, electrical installations etc.

#### **installing the independent link pipe:**

1. **for Evolution exhaust only:** coat the interior side of the input of the titanium link pipe with Akrapovic ceramic anti-seizing grease (white tube)
2. correctly insert the lambda sensor (Figure 16)
3. slide the link pipe onto the header tubes and attach the springs (Figure 17)
4. tighten the lambda sensor (Figure 18)
5. make sure the link pipe is not touching the engine and other parts of the motorcycle

#### **installing the muffler:**

1. **for Evolution exhaust only:** coat the interior side of the input of the inlet cap (muffler) with Akrapovic ceramic anti-seizing grease (white tube)
2. correctly position and slide the Akrapovic muffler onto the link pipe (Figure 19)
3. attach the springs (Figure 20)
4. correctly position the carbon-fiber clamp and slide it onto the muffler, bear in mind the **right offset** of the carbon-fiber clamp viewed from the rear. **WARNING:** open the clamp to slightly wider than the diameter of the outer sleeve of the muffler – do not scrape it along the muffler outer sleeve! (Figure 21, 22)
5. tighten the carbon-fiber clamp onto the stock chassis hanging bracket on the frame – beside stock bolt and nut use the washer supplied in the Akrapovic kit. Do not fully tighten. (Figure 23, 24)
6. make sure the muffler is not touching other parts of the motorcycle

#### **final installation:**

1. tighten the bolts on all of the brackets, clamps and header tube flanges to which the exhaust system is attached
2. clean grease spots:
  - a. muffler – titanium outer sleeve: use a soft cloth sprayed with a multi-purpose spray lubricant (WD-40 or equivalent)
  - b. muffler – carbon-fiber outer sleeve: use a soft dry cloth
  - c. RACING - stainless steel link pipe, collector, header tubes: use a soft cloth sprayed with a contact cleaner, then wipe with a soft dry cloth
  - d. EVOLUTION - titanium link pipe, collector, header tubes: use a soft cloth sprayed with a multi-purpose spray lubricant (WD-40 or equivalent)

Cleaning will prevent spots from burning onto the surface. Do not use aggressive chemical cleaners, because they can damage the sticker.

3. position of the installed Akrapovic Racing or Evolution system (Figure 25)

**Check the operation of the brakes and suspension. Make sure all the bolts are sufficiently tightened. In case the exhaust system touches the cowling or other parts repeat the adjustment of the exhaust system or contact your authorized dealer.**

**! IT IS NORMAL IF WHITE SMOKE COMES OUT OF THE MUFFLER ON FIRST OPERATION.**

**! DO NOT STAND BEHIND THE MUFFLER ON FIRST OPERATION.**

**! DO NOT USE AUTOMOTIVE WHEEL CLEANERS OR ANY CLEANING PRODUCTS WHICH CONTAIN ACIDIC ADDITIVES TO CLEAN AKRAPOVIC EXHAUST SYSTEMS.**

#### **MAINTENANCE OF THE AKRAPOVIC EXHAUST SYSTEM**

1. Clean the titanium muffler outer sleeve with a multi-purpose spray lubricant (WD-40 or equivalent ) and carbon fiber outer sleeve with soft and dry cloth. Do not use aggressive chemical cleaners, because they can damage the sticker. A change in the color of the exhaust system is normal due to the high temperatures.
2. The wearing out of the muffler silencing material depends on the type of the motor and riding style. Contact your dealer/serviceman if visible changes appear on muffler's outer sleeve or the noise level is increased.
3. Periodically ensure that all the bolts and springs are sufficiently tight.

#### **Photos:**



*Figure 1*



*Figure 2*



*Figure 3*



*Figure 4*



*Figure 5*



*Figure 6*

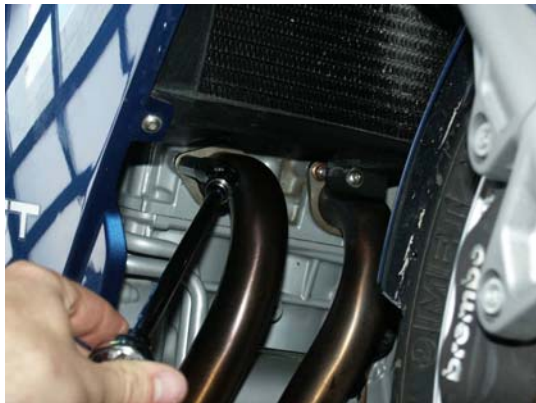

Figure 7



Figure 8



Figure 9



Figure 10

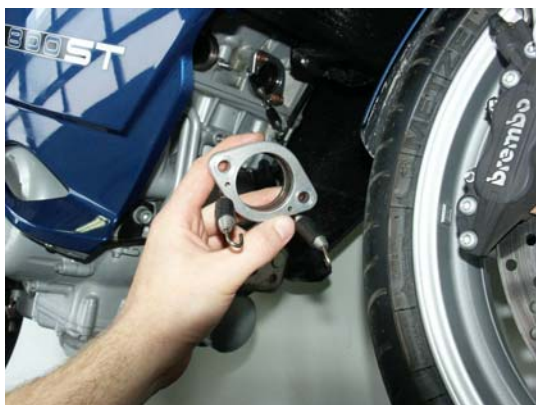

Figure 11

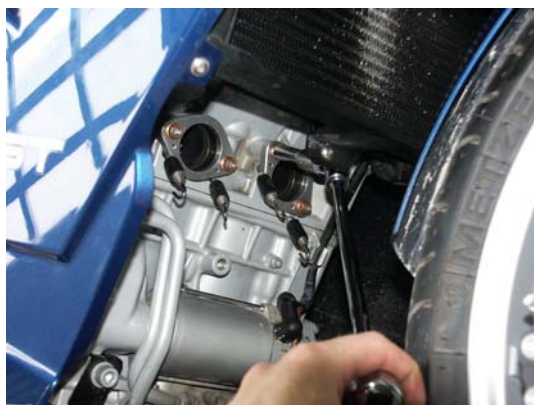

Figure 12



Figure 13



Figure 14



Figure 15



Figure 16



Figure 17



Figure 18



Figure 19



Figure 20



Figure 21



Figure 22



Figure 23



Figure 24



Figure 25

BMW F 800 S/ST, Complete exhaust system, Racing line, Open, Model year: 2006 - 2009

Product code: 106124 (S-B8R1L-LT)  
106125 (S-B8R1L-LC)

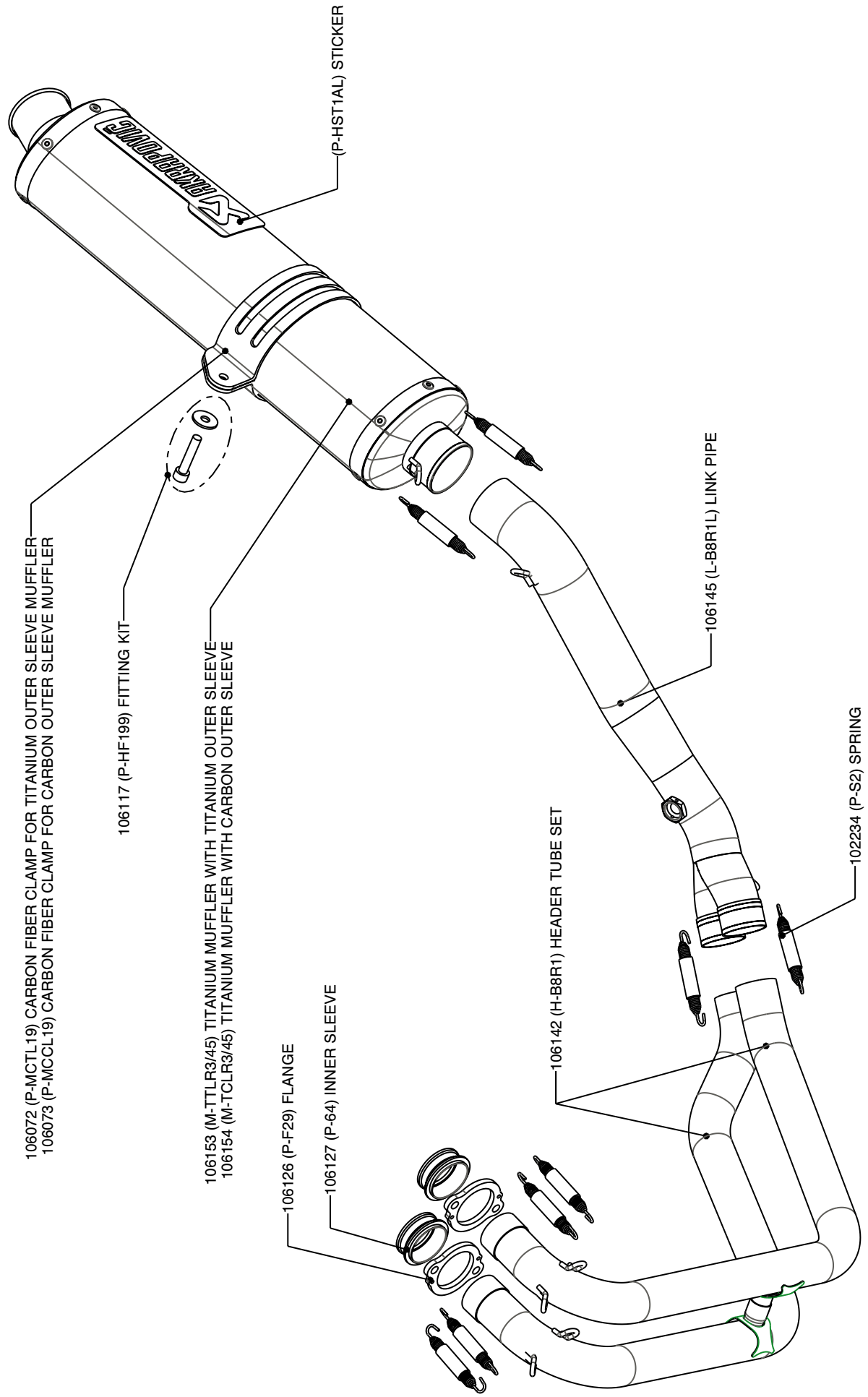

BMW F 800 S/ST, Complete exhaust system, Evolution line, Open, Model year: 2006 - 2009

Product code: 106120 (S-B8RFT1TL-LT)  
106121 (S-B8RFT1TL-LC)

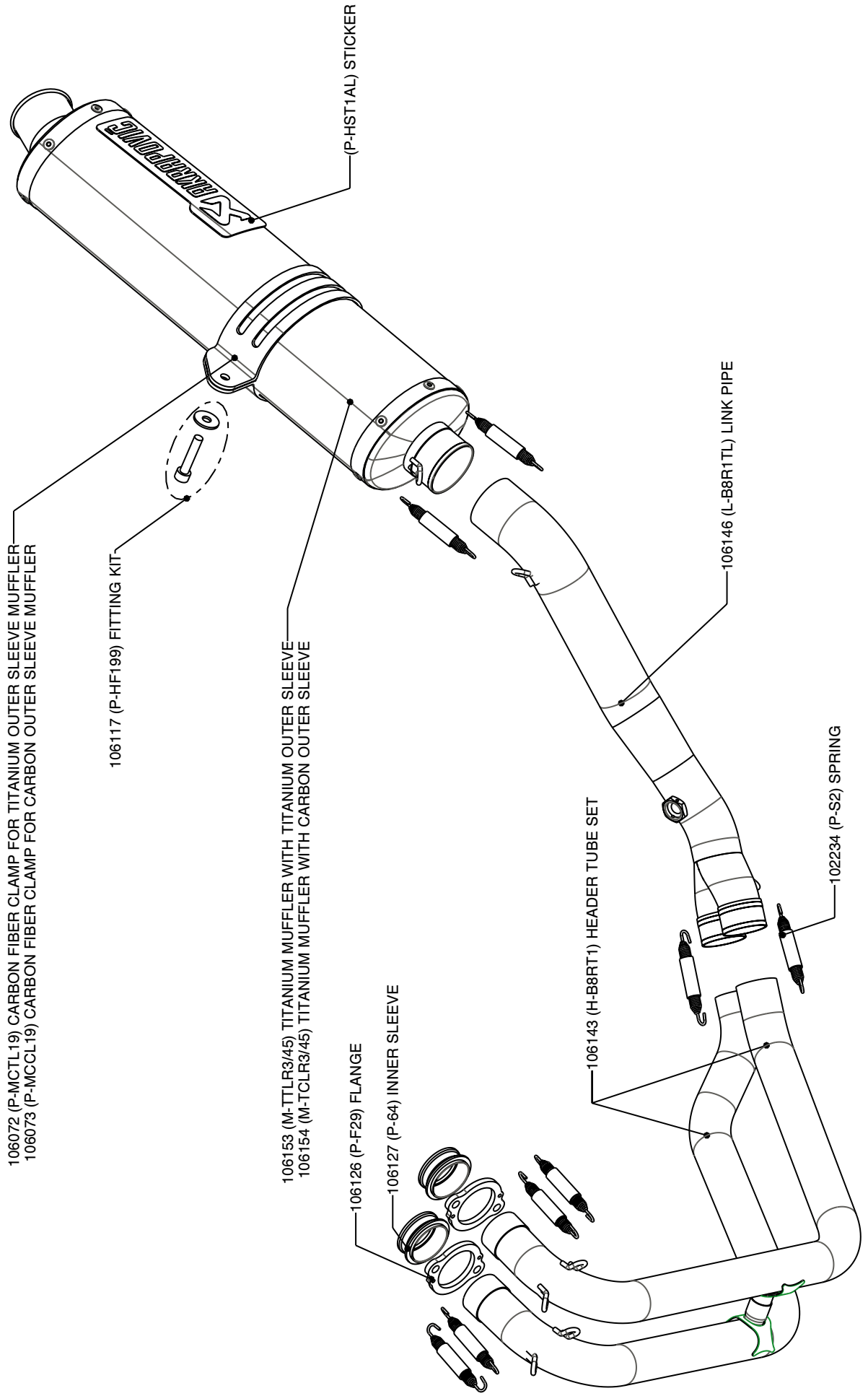

BMW F 800 S/ST, Complete exhaust system, Racing line, Street legal, Model year: 2006 - 2009

Product code: 106122 (S-B8R1L-HLT)  
106123 (S-B8R1L-HLC)

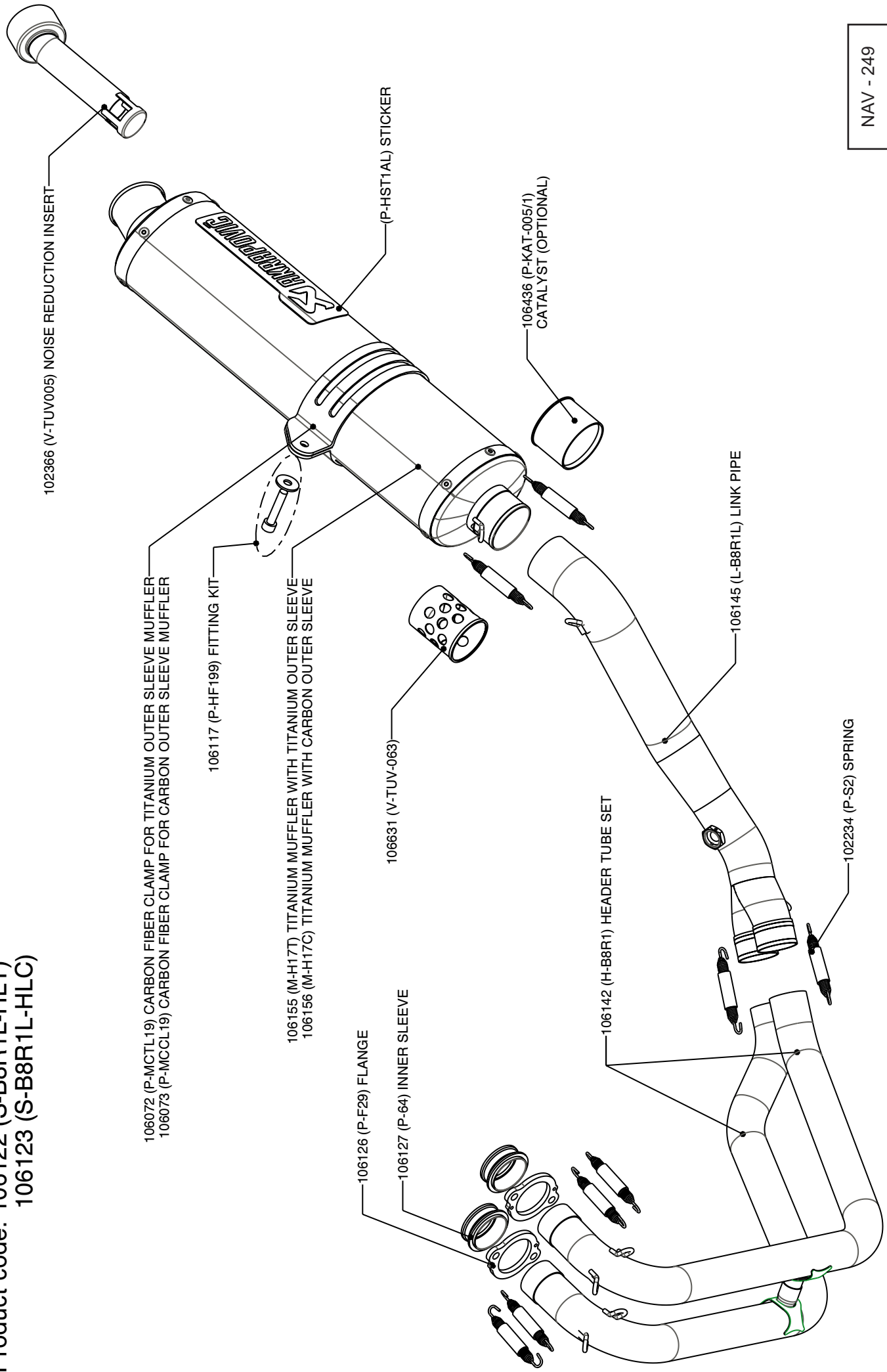

BMW F 800 S/ST, Complete exhaust system, Evolution line, Street legal, Model year: 2006 - 2009

Product code: 106118 (S-B8RFT1TL-HLT)  
106119 (S-B8RFT1TL-HLC)

