



Honda CB 1300 (2003-2005)

Sport Production Exhaust System

Akrapovic Sport Production Exhaust System

for the Honda CB 1300 (2003-2005)

The Honda CB 1300 is one of the biggest naked bikes on the market. And it comes from Honda's legendary CB series, whose reputation is well known. Its retro styling and modern engine make for a pleasing package for all fans of this type of bike.

GOAL

The Akrapovic SPORT PRODUCTION complete exhaust system offers a little bit more than the SLIP-ON partial system. We're talking here about engine performance, which is a major priority when tuning the entire exhaust system. Therefore the Akrapovic SPORT PRODUCTION system is the right choice for those for whom the Slip-On system is not sufficient, and who are ready to modify their entire exhaust system.

ABOUT AKRAPOVIC SPORT PRODUCTION SYSTEMS

The Akrapovic SPORT PRODUCTION exhaust system is the first level in our range of complete exhaust systems, which totally replace the stock systems. The configuration for the Honda CB 1300 is 4-2-1.

The tubes for Akrapovic SPORT PRODUCTION exhaust systems are made of high-quality stainless steel, whose polish makes them match the lines of naked bikes beautifully – including the mighty Honda. The header tubes are cylindrical, as is the link pipe in the case of the Honda. The component parts are attached to each other through the use of free-floating joints which are secured using high-quality silicon-shielded tensioning springs.

At the back is the familiar Akrapovic oval-section muffler, held in place using the Akrapovic carbon-fiber clamp, which is ideally suited to its task of minimizing vibrations and unwanted movement. The outer sleeve of the muffler is available in either the racing-style black woven pattern of carbon-fiber or the refined satin sheen of titanium. There is no difference in performance between the two materials, nor does the choice affect the sound. It's simply a matter of your aesthetic choice of which one fits the lines of the Honda better. We also pay special attention to guaranteeing the minimal weight of our

systems. Therefore all metal parts in the interior of the muffler are made exclusively of titanium. The weight savings of over 48% over the stock exhaust attests to the quality of the materials and the precision manufacturing of the system.

Measurements of the Akrapovic SPORT PRODUCTION system on the Honda CB 1300:

• power:

If we achieved a good result with the Slip-On system, then it would be logical to conclude that the results with the SPORT PRODUCTION system should be even better. With this exhaust system your engine will offer a full 14 HP more than the stock system, which means that at 8000 rpm the rear wheel will receive 121.3 HP. The shape of the power curve essentially follows the stock curve, but the increased power puts the curve much higher up on the graph.

• torque:

The torque curve also receives benefits from the installation of our exhaust system. Up to 2300 rpm the results are slightly lower than the stock system, above which the engine starts to put out a huge amount of torque. This allows the rider to shift gears fluidly no matter what riding style is chosen.

If you are looking to tune up the exhaust system of your CB 1300, the Akrapovic SPORT PRODUCTION system is definitely an excellent choice. The proof lies in the major performance increase, the significant weight savings and the aesthetic and sonic enhancement offered by a renowned brand name.

	stock	AKRAPOVIC		difference	
		S.S.	titanium	stock - S.S.	stock - titanium
weight comparison	10.68 kg	5.50 kg	-	5.18 kg	-
max. rear wheel power	107.3 / 7750 RPM	121.3 HP / 8000 RPM		14.5 HP / 7850 RPM*	
noise measurement	87.2 db / 3750 RPM	96.3db / 3750 RPM		9.1 db / 3750 RPM	
legal for street use	NO				

*MAXIMUM MEASURED POWER DIFFERENCE

Technical specifications of Akrapovic exhaust systems and related products subject to change without notice.

Akrapovic Sport Production Exhaust System

for the Honda CB 1300 (2003-2005)



Road Program

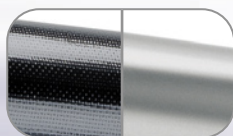

The outer sleeve is available in carbon-fiber or titanium



CARBON-FIBER MUFFLER CLAMP

Product code: S-H13S2-T, S-H13S2-C

Akrapovic Sport Production Exhaust System for the Honda CB 1300 (2003-2005)



Akrapovic Exhaust System Technology copyright 2003, all rights reserved

Road
Program

Akrapovic Sport Production Exhaust System for the Honda CB 1300 (2003-2005)



Akrapovic Exhaust System Technology copyright 2003, all rights reserved

Road
Program

Product code: S-H13S2-T, S-H13S2-C

Akrapovic Sport Production Exhaust System

for the Honda CB 1300 (2003-2005)

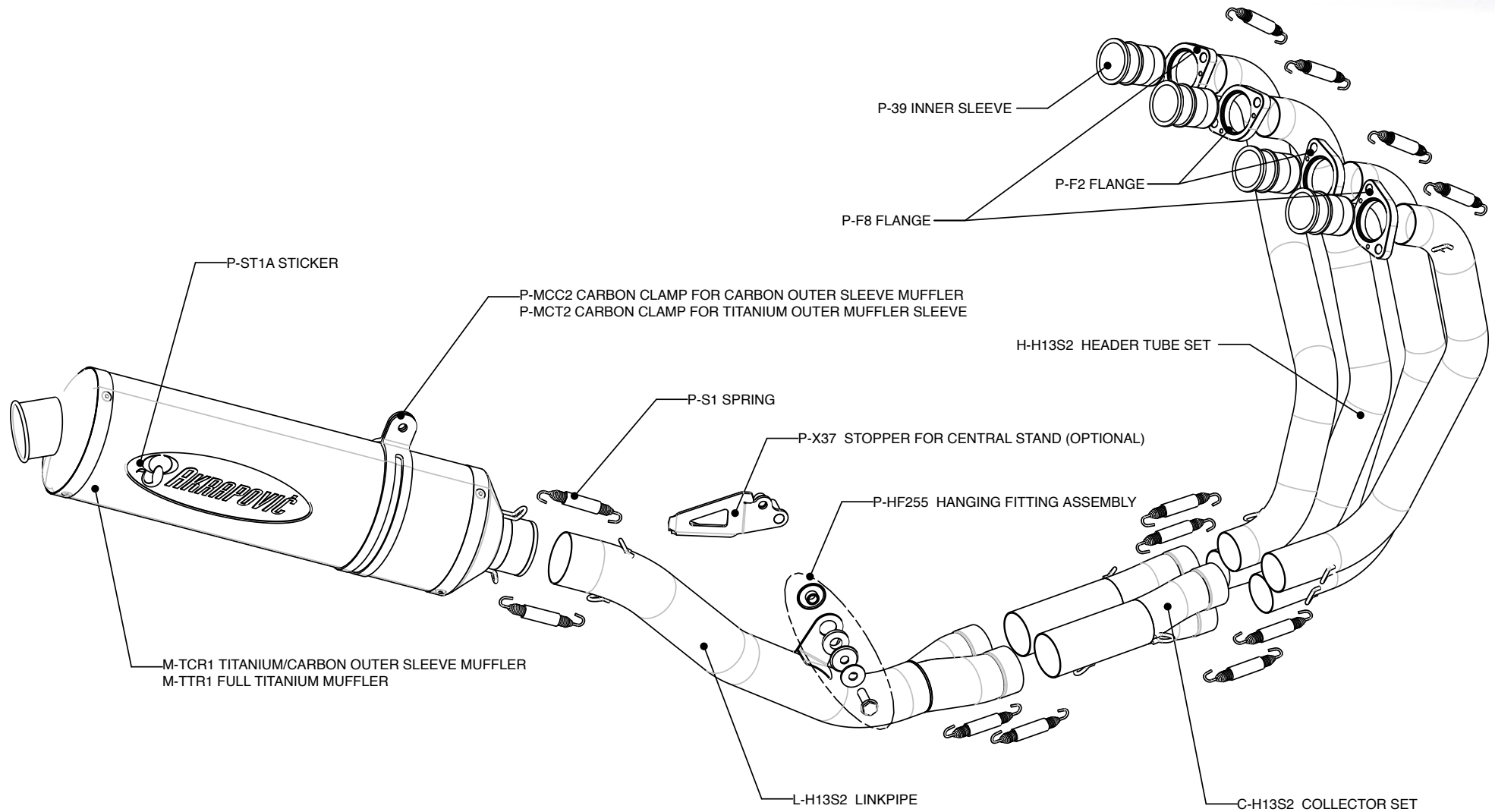

Akrapovic Exhaust System Technology copyright 2003, all rights reserved

Road Program

Akrapovic Sport Production Exhaust System

for the Honda CB 1300 (2003-2005)

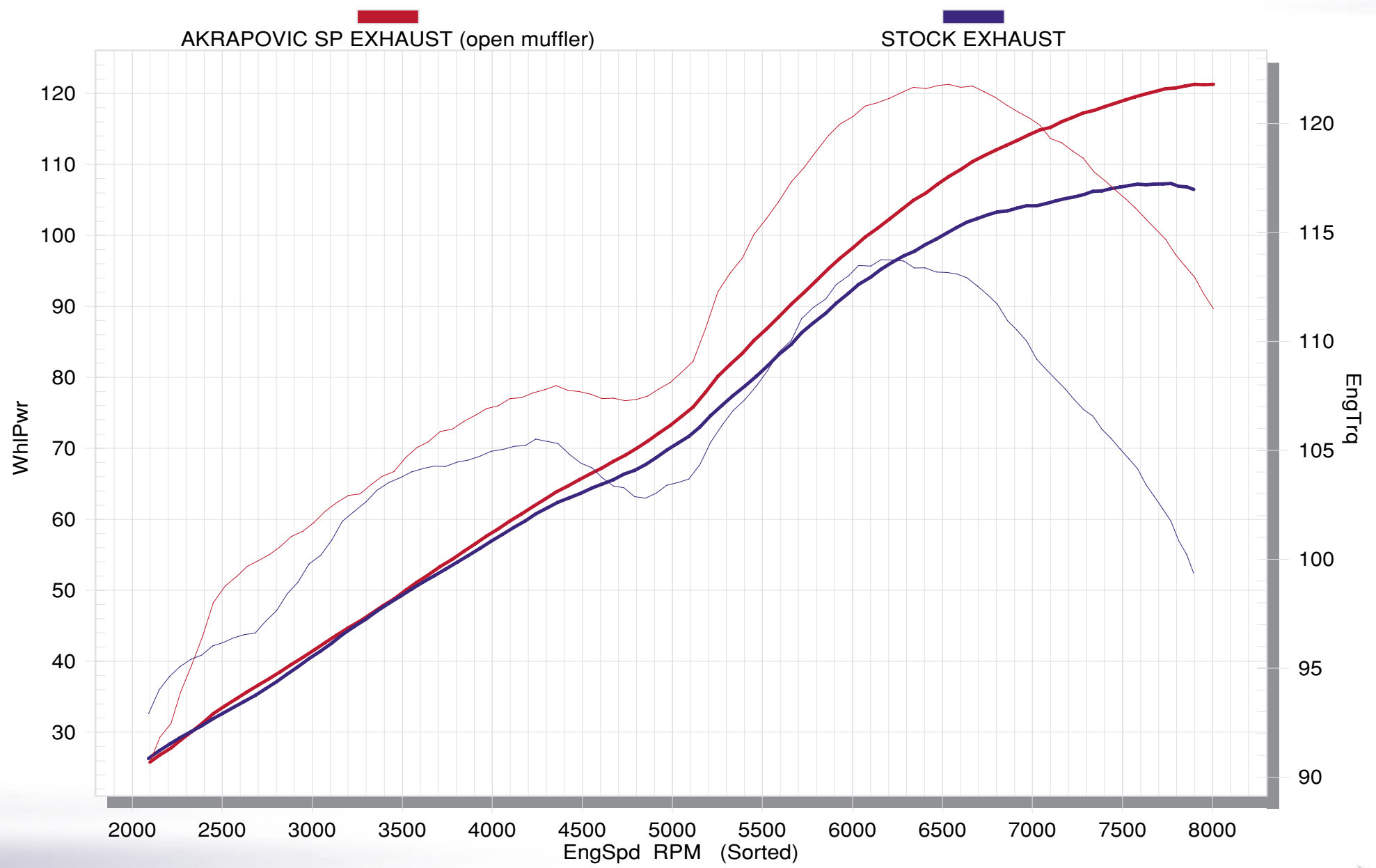

Road Program

Akrapovic Exhaust System Technology copyright 2003, all rights reserved

