



Kawasaki ZX 9R (2002, 2003)

Slip-on Exhaust System

# Akrapovic Slip-On Exhaust System

for the Kawasaki ZX 9R (2002, 2003)

The Kawasaki ZX 9R. A bike which still keeps right up with the rest of the Supersport bikes in the modern "1 liter" category. Although it is the smallest in terms of displacement, this has never affected its excellent performance. It is as elegant as ever, and even offers a comfortable ride for everyday use. A powerful drive train and precise handling make for a superior package which never disappoints.

## GOAL

For those who wish to make a modification to their exhaust system without any modifications to the bike itself, we have developed a simple solution with a major effect. This is the Akrapovic SLIP-ON system, which was mainly designed to provide aesthetic pleasure, but which has surprised a lot of people with its performance. It is quite a step up from the stock specs for the Kawasaki ZX 9R.

## ABOUT AKRAPOVIC SLIP-ON SYSTEMS

The Akrapovic SLIP-ON system fits elegantly into the lines of the Kawasaki; they look like they were made for each other. We mentioned that the main purpose of this system is to improve the look of the bike. If we want to fulfill this criterion, the workmanship has to be first-rate. With our system, this is apparent even to the untutored eye.

The Akrapovic SLIP-ON system is composed of a cylindrical link pipe made of high-quality stainless steel attached with floating connections to the muffler on one end and to the header assembly on the other. Both connections are held together with high-quality silicon-shielded springs. A titanium link pipe is available as an option.

The muffler for this SLIP-ON system is oval section and is mounted on the right side. The outer sleeve is available in your choice of the black gleam of carbon-fiber or the satin sheen of titanium. This is purely a matter of taste, as performance is not affected by the choice! The muffler is mounted in the standard position and held in place with a carbon-fiber clamp as used by factory teams. The standard mounting position means that the stock chassis hanging bracket can be used.

## Measured performance of the Akrapovic SLIP-ON system for the Kawasaki ZX 9R:

**• power:**  
the Akrapovic SLIP-ON system increases power throughout the entire rpm range. This increase is exceptionally linear and constant; the greatest effect is felt at around 6000 rpm, where our system manages to smooth out the drop-out in the stock power curve, and towards the top end, where it generates a maximum horsepower of 136 HP.

**• torque:**  
the Akrapovic SLIP-ON system shows its quality most of all with a look at the progression of the torque curve. Once again the excellent design of the system becomes apparent: torque is increased throughout the entire rpm range, giving the motor an exceptional amount of flexibility. The violent fluctuations in the torque curve between 5600 and 6200 rpm are eliminated, making the motor run smoother and providing a much steadier application of torque for the rider.

## What do you get with an Akrapovic SLIP-ON system?

Aesthetic enhancement of the lines of the bike, an instantly recognizable sound, significant weight savings, an exceptionally high-quality product, a renowned brand name, and a substantial improvement to the performance of the engine of your ZX 9R. And all this with a system which is essentially simple to install.

The Akrapovic SLIP-ON system is an excellent combination of all the above-mentioned qualities, at a remarkably affordable price! For those who desire even higher performance from their Kawasaki, we also offer complete exhaust systems from our RACING and EVOLUTION lines.

	stock	AKRAPOVIC		difference	
		S.S.	titanium	stock - S.S.	stock - titanium
weight comparison	7.30 kg	2.10 kg	1.89 kg	5.20 kg	5.41 kg
max. rear wheel power	130 HP / 10500 RPM	136 HP / 11000 RPM		9HP / 11800 RPM*	
noise measurement	93 db / 5500 RPM	96.8 db / 5500 RPM		3.8 db / 5500 RPM	
periodic service possibilities without taking off A.E.S.	oil			oil filter	
	YES			NO	
legal for street use	NO				

\*MAXIMUM MEASURED POWER DIFFERENCE

Technical specifications of Akrapovic exhaust systems and related products subject to change without notice.



# Akrapovic Slip-On Exhaust System

for the Kawasaki ZX 9R (2002, 2003)



Akrapovic Exhaust System Technology copyright 2003, all rights reserved

Road Program



The outer sleeve is available in carbon-fiber or titanium



Link pipe is made of stainless steel or sandblasted titanium (optional)



CARBON-FIBER MUFFLER CLAMP

Product code: S-K9SO1-C, S-K9SO1-T, S-K9SO1T-C, S-K9SO1T-T



# Akrapovic Slip-On Exhaust System for the Kawasaki ZX 9R (2002, 2003)



Akrapovic Exhaust System Technology copyright 2003, all rights reserved

Road  
Program

# Akrapovic Slip-On Exhaust System for the Kawasaki ZX 9R (2002, 2003)



Akrapovic Exhaust System Technology copyright 2003, all rights reserved

Road  
Program

# Akrapovic Slip-On Exhaust System

for the Kawasaki ZX 9R (2002, 2003)

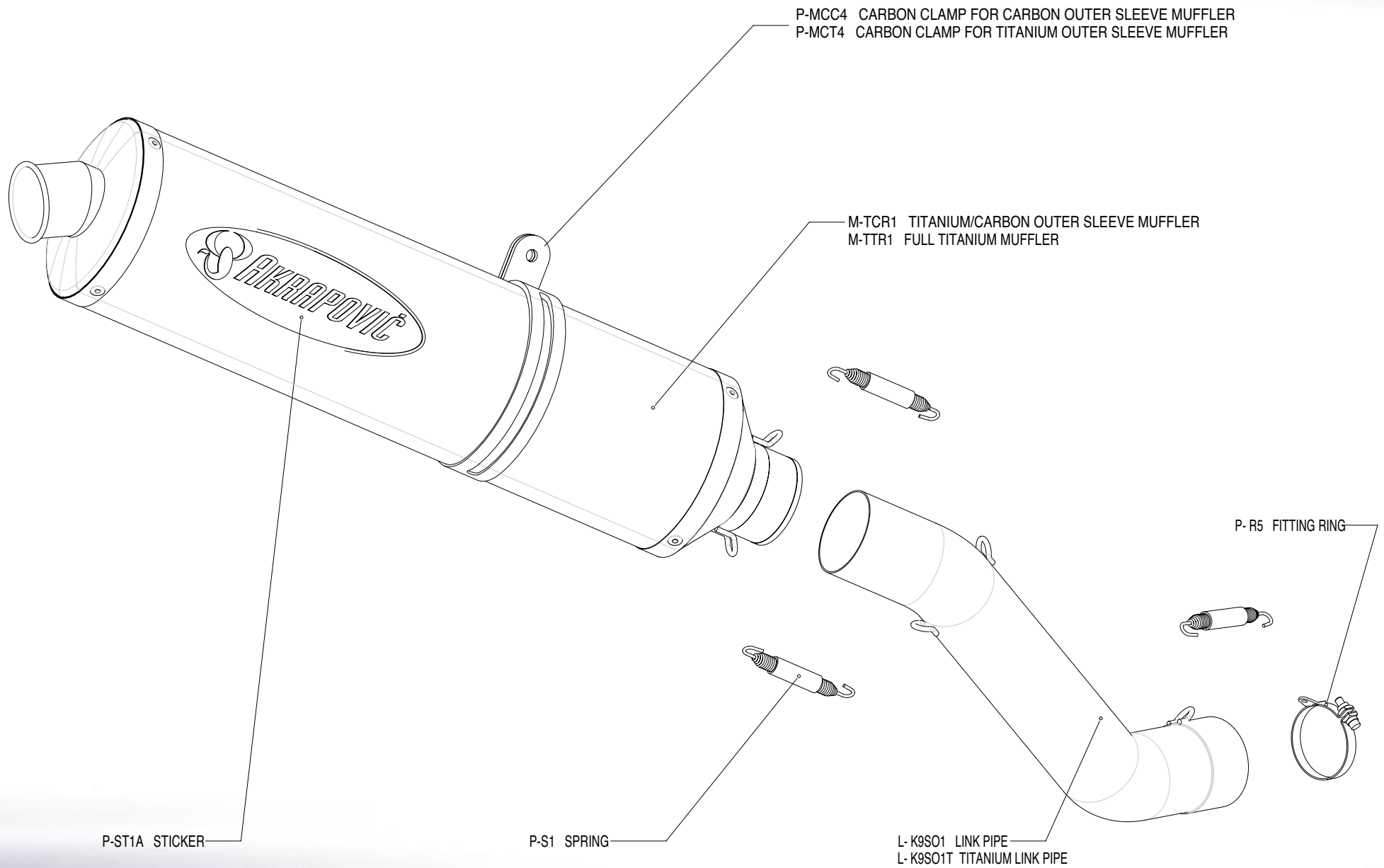

Akrapovic Exhaust System Technology copyright 2003, all rights reserved

Road Program



# Akrapovic Slip-On Exhaust System

for the Kawasaki ZX 9R (2002, 2003)

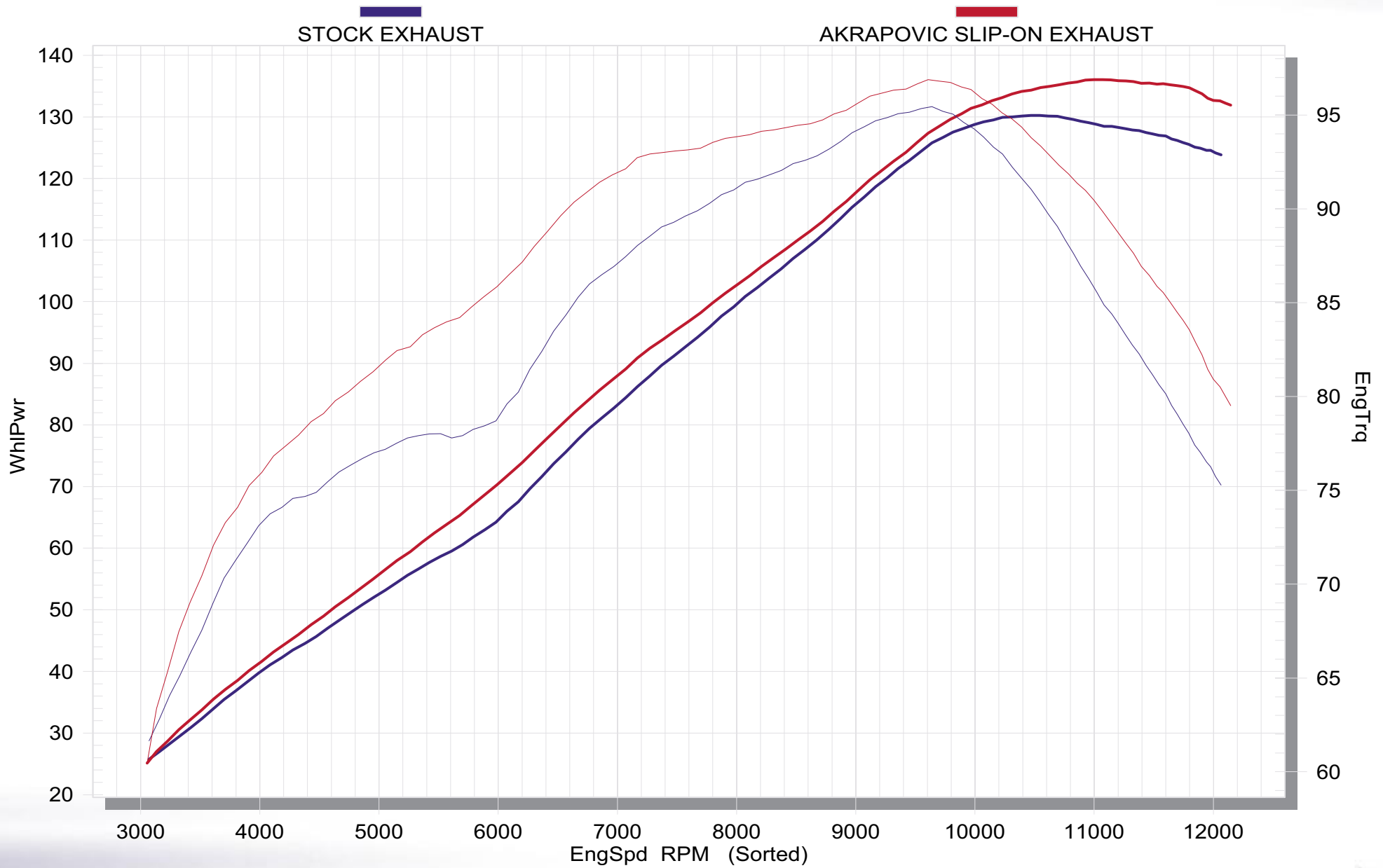

Akrapovic Exhaust System Technology copyright 2003, all rights reserved

Road Program

