



**AKRAPOVIC EVOLUTION EXHAUST SYSTEM**  
for the  
**APRILIA RSV MILLE & TUONO 1000 (2007- 2009)**

**Congratulations on purchasing an Akrapovic exhaust system. Please read these installation instructions carefully. If you have any trouble installing the system please contact your authorized dealer!**

**IMPORTANT INFORMATION**

**Exclusion of Certain Liability**

1. The manufacturer, importer or dealer shall not be liable for any incidental damage including personal injury or any other damages caused by improper installation or operation of the Akrapovic exhaust system. When installing the Akrapovic exhaust system be careful that the exhaust system does not touch other parts sensitive to high temperature.
2. Akrapovic makes no representation or warranties with regard to damage caused by the improper installation, use and maintenance of the Akrapovic exhaust system. The warranty is limited to defects recognized by our technical department and to normal use, and excludes items subject to normal wear (gaskets and damping wool). The guarantee is void in case of accident, modification, improper or competition use.
3. Do not attempt to install the Akrapovic exhaust system on a motorcycle for which it was not made or tested by Akrapovic.
4. When the exhaust system gets very hot during operation, be careful not to burn yourself on the exhaust system or parts which are in direct contact with it, even when the motor is not running. Also protect other people, especially children, from the injuries mentioned above.
5. In some cases Akrapovic exhaust system kits contain chemical products (ceramic anti-seizing grease; bolt sealant). Handle with care, do not inhale or swallow. Avoid excessive contact with skin, eyes or mucous membranes. Keep out of reach of children.
6. Technical specifications of Akrapovic exhaust systems and related products subject to change without notice.

**Trademarks**

The Akrapovic Exhaust System Technology logo is a registered trademark of Akrapovic d.d.

**Akrapovic website**

Information about Akrapovic exhaust systems and related products is available on the Akrapovic website at:

**<http://www.akrapovic.com/>**

**Copyright**

No part of the Akrapovic exhaust system or its documentation may be reproduced or distributed in any form or by any means without the prior written authorization of the Akrapovic company.

© Akrapovic, d.d. All rights reserved.

**Symbols**

The following symbols are used throughout these installation instructions:



 **USE BOLT SEALANT;** Apply 3 to 4 small drops of bolt sealant onto the cleaned and degreased threads before tightening bolts. **WARNING! Avoid contact with skin, eyes and mucous membranes. Do not inhale fumes. Keep out of the reach of children.**

 **USE ANTI-SEIZING GREASE (white tube);** Prevents seizing, corrosion and excessive wear between the titanium components of your exhaust system. **WARNING! Avoid eye contact. Avoid excessive skin contact. Keep out of the reach of children.**

 **USE ANTI-SEIZE LEAD-FREE COPPER PASTE (black tube);** Provides trouble-free and long-lasting protection against seizing, corrosion and rusting of bolts, threaded ends, nuts, joints, etc. Also protects against vibration, wear and impact. **WARNING! Avoid eye contact. Avoid excessive skin contact. Keep out of the reach of children.**

## **INSTALLATION INSTRUCTIONS**

 BEFORE INSTALLING CHECK SCHEMATIC OF THE EXHAUST SYSTEM!

! IF ANY ITEMS IN THE AKRAPOVIC EXHAUST SYSTEM PACKAGE ARE MISSING PLEASE CONTACT YOUR AUTHORIZED DEALER. KEEP THE SCHEMATIC FOR FUTURE REFERENCE.

! THESE INSTALLATION INSTRUCTIONS MUST BE READ CAREFULLY IN ORDER TO ENSURE PROPER INSTALLATION AND OPERATION OF THE AKRAPOVIC EXHAUST SYSTEM.

! THE EXHAUST SYSTEM CAN BE EXTREMELY HOT. ALLOW THE MOTORCYCLE TO COOL DOWN BEFORE BEGINNING INSTALLATION.

 WE ADVISE YOU TO LEAVE INSTALLATION TO A QUALIFIED SERVICEMAN. IMPROPER INSTALLATION MAY RESULT IN A SHORTER LIFETIME OF THE EXHAUST SYSTEM AND/OR DAMAGE TO THE MOTORCYCLE.



T-handle 13mm wrench  
T-handle swiveling 10mm wrench  
T-handle 4mm swiveling three hexagon key wrench  
T-handle 4mm three hexagon key wrench  
T-handle 6mm three hexagon key wrench  
Combination 10mm wrench  
Combination 15mm wrench  
Combination 22mm wrench  
Spring puller

### **REMOVAL OF STOCK EXHAUST SYSTEM:**

1. Put the motorcycle on a side stand, we recommend a racing stand. Make sure, that surface is solid and flat.
2. Unscrew the bolts from the muffler bracket (**Figure 1**). Unhook the stock springs and remove the mufflers with welded link-pipes (**Figure 2, 3**).



*Figure 1*



*Figure 2*



*Figure 3*

3. Remove the lower parts of the cowling (Figure 4, 5, 6). Unscrew and remove the oil cooler into a position which allows the stock front header tube to be removed; **warning: do not disconnect the coolers tubes** ; make sure not to damage the cooling fins (Figure 7, 8).



Figure 4



Figure 5



Figure 6



Figure 7



Figure 8

4. Unscrew and remove the lambda sensor (**Figure 9**). Remove the rubber distance cap (**Figure 10**). Unhook the springs on the collector (collector – header tube joint) (**Figure 11**). Slightly unscrew the flanges on the stock header tubes (**Figure 12, 13**). Remove the collector (**Figure 14**). Completely unscrew the nuts on the flanges of the stock header tubes and remove the headers (**Figure 15**).



**Figure 9**



**Figure 10**



**Figure 11**



**Figure 12**



**Figure 13**



**Figure 14**



Figure 15

**INSTALLATION OF THE AKRAPOVIC EVOLUTION EXHAUST SYSTEM:**

1. Tighten the front and rear header tubes (Figure 16, 17).

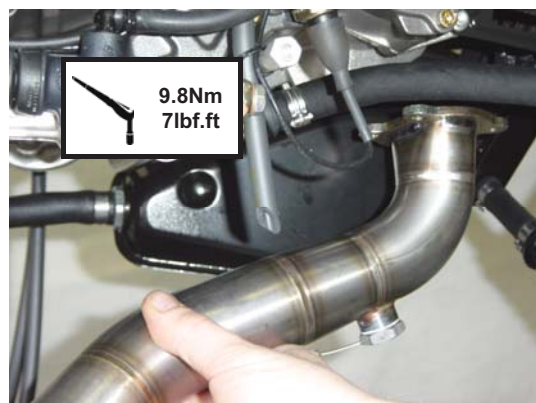

Figure 16

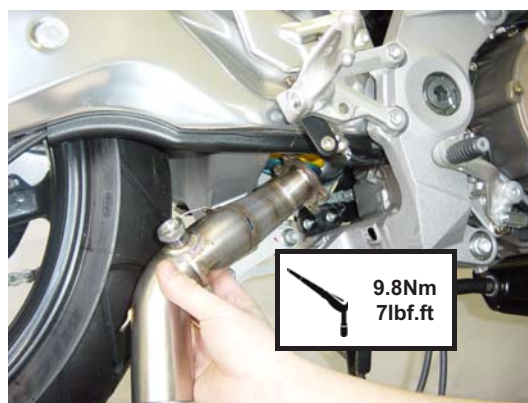

Figure 17

2. Slide the collector onto the headers and attach the springs (Figure 18, 19).



Figure 18



Figure 19

3. Tighten the lambda sensor and attach the stock rubber distance cap to Akrapovic collector (Figure 20, 21).

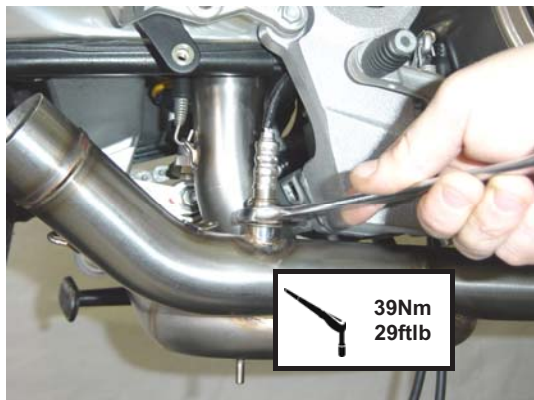

Figure 20



Figure 21

4. Reattach the oil cooler in the reverse order from the order in which it was removed (Figure 22). Correctly assemble the collector bracket (Figure 23) and press on nut on the collector (Figure 24). Unscrew the side stand ; **WARNING** : put the motorcycle on a racing stand first! Make sure, that surface is solid and flat (Figure 25). Correctly insert the collector bracket and tighten the side stand and bracket to collector bolt (Figure 26, 27, 28, 29).



Figure 22



Figure 23



Figure 24



Figure 25



Figure 26

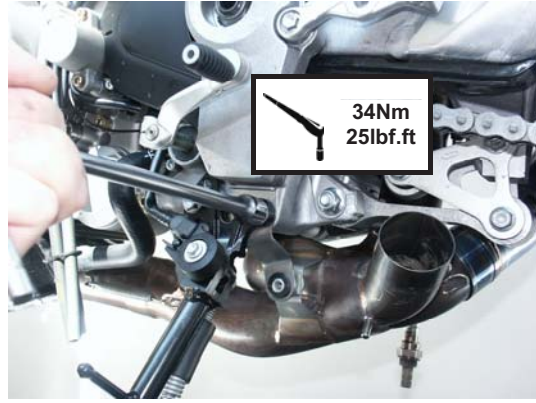

Figure 27



Figure 28



Figure 29

5. Correctly assemble the heatshields onto the Akrapovic link-pipes (**Figure 30, 31, 32**). Slide the link pipes onto the collector - coat the interior side of the input bush of the link pipes with Akrapovic ceramic anti-seizing grease (white tube) and attach the springs (**Figure 33, 34**).



Figure 30



Figure 31

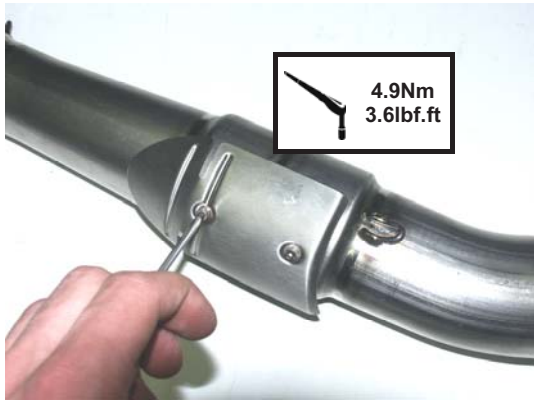

Figure 32

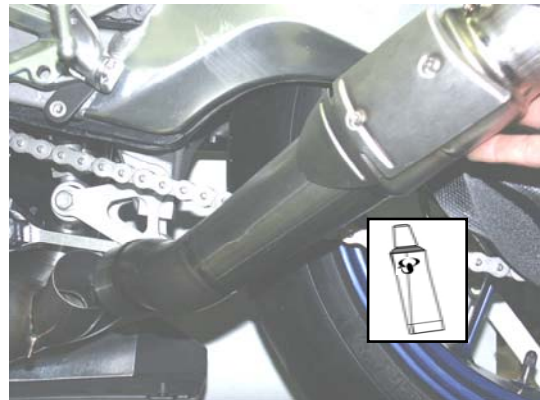

Figure 33



Figure 34

- Slide the mufflers onto the link pipes (Figure 35). For Evolution exhaust only: coat the interior side of the input of the muffler with Akrapovic ceramic anti-seizing grease (white tube). Attach the Akrapovic springs (Figure 36). Correctly position the carbon-fiber clamps (left side: TR16/CR16 ; right side: TR17/CR17) and slide them onto the mufflers (Figure 37). **WARNING:** open the clamps slightly wider than the diameter of the outer sleeve of the mufflers – do not scrape them along the mufflers outer sleeve! Be careful not to damage paint or any other part of the motorcycle during this process! Align the mufflers. Correctly assemble and tighten the stock bolts, washers and nuts on the carbon clamps – muffler bracket joints (Figure 38, 39, 40). Make sure the mufflers or link pipes are not touching the frame or any other parts of the motorcycle.

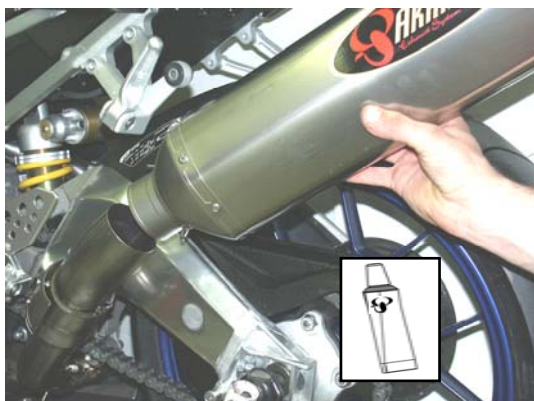

Figure 35



Figure 36



Figure 37



Figure 38



Figure 39



Figure 40

**final installation:**

1. Reassemble all of the dismantled stock parts and cowlings in the reverse order from the order in which they were removed.
2. Clean grease spots:
  - a. Muffler – titanium outer sleeve: use a soft cloth sprayed with a multi-purpose spray lubricant (WD-40 or equivalent).
  - b. Muffler – carbon-fiber outer sleeve: use a soft dry cloth.
  - c. Muffler – carbon-fiber outlet cap: use a soft dry cloth.
  - d. EVOLUTION exhaust: stainless steel header tubes: use a soft cloth sprayed with a contact cleaner, then wipe with a soft dry cloth ; titanium collector and link pipes: use a soft cloth sprayed with a multi-purpose spray lubricant (WD-40 or equivalent).

Cleaning will prevent spots from burning onto the surface. Do not use aggressive chemical cleaners, because they can damage the sticker.

Position of the correctly installed Akrapovic **EVOLUTION** exhaust system (Figure 41, 42).



Figure 41



Figure 42

3. Check the operation of the brakes and suspension. Make sure all the bolts are sufficiently tightened. In case the exhaust system touches the cowling or other parts repeat the adjustment of the exhaust system or contact your authorized dealer.

**! IT IS NORMAL IF WHITE SMOKE COMES OUT OF THE MUFFLER ON FIRST OPERATION.**

**! DO NOT STAND BEHIND THE MUFFLER ON FIRST OPERATION.**

**! DO NOT USE AUTOMOTIVE WHEEL CLEANERS OR ANY CLEANING PRODUCTS WHICH CONTAIN ACIDIC ADDITIVES TO CLEAN AKRAPOVIC EXHAUST SYSTEMS.**

#### **MAINTENANCE OF THE AKRAPOVIC EXHAUST SYSTEM**

1. Clean the titanium exhaust components with a multi-purpose spray lubricant (WD-40 or equivalent ), carbon fiber exhaust components with soft and dry cloth and stainless steel components with soft cloth sprayed with contact cleaner, then wipe with soft and dry cloth. Do not use aggressive chemical cleaners, because they can damage the sticker. A change in the color of the exhaust system is normal due to the high temperatures.
2. The wearing out of the muffler silencing material depends on the type of the engine and riding style. Contact your dealer/serviceman if visible changes appear on muffler's outer sleeve or the noise level is increased.
3. Periodically make sure all the bolts and springs are sufficiently tight.

APRILLIA RSV 1000/ TUONO/ Complete exhaust system/ EVOLUTION LINE, model year: 2007 - 2009/ OPEN

Product code: S-A10E7T-RC  
S-A10E7T-RT

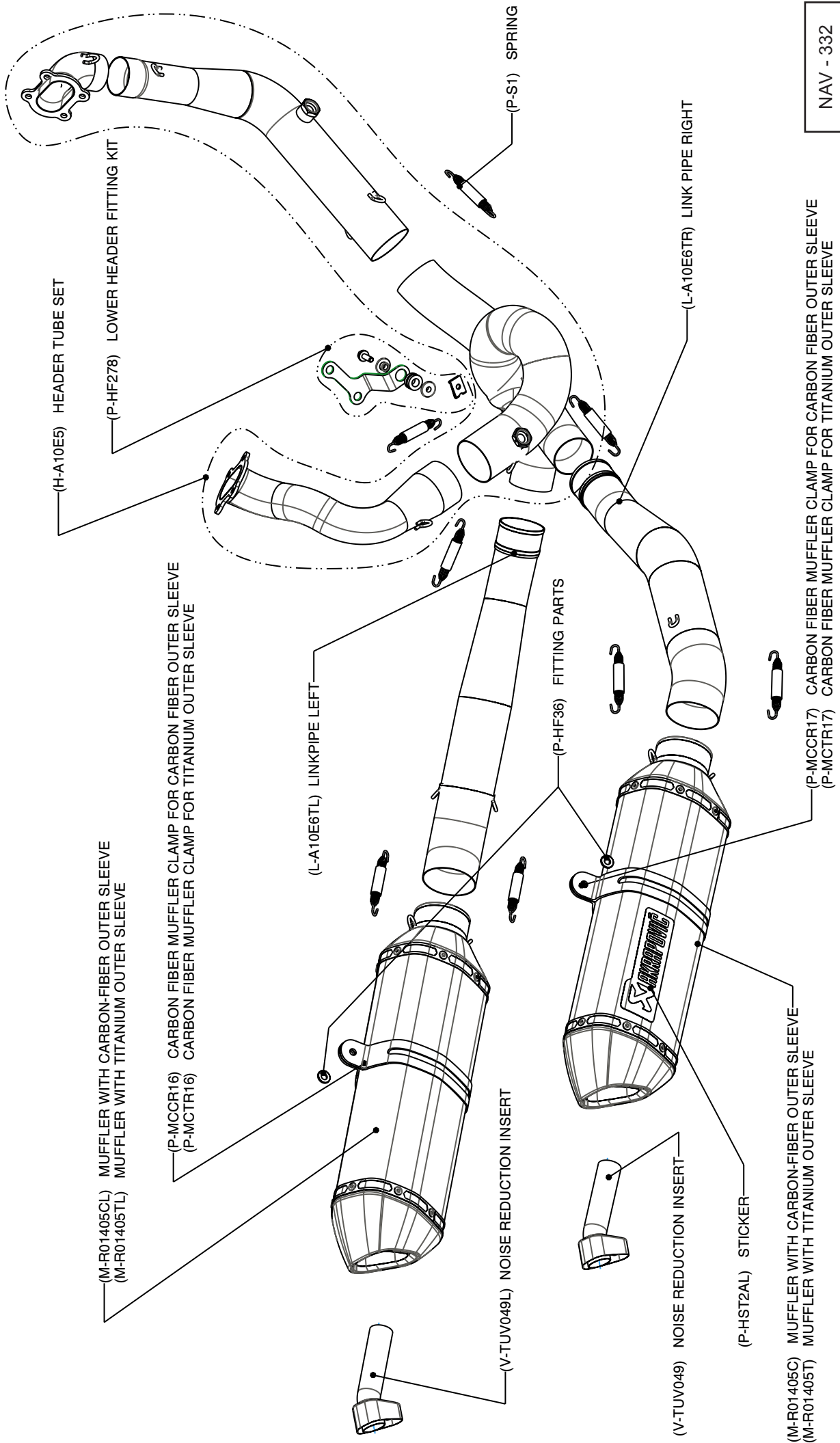

APRILLIA RSV 1000/ TUONO/ Complete exhaust system/ EVOLUTION LINE, model year: 2007-2009/ Street legal

Product code: S-A10E7TC-HRT  
S-A10E7TC-HRC

