



Yamaha TT-R 125L (2000 - 2005)

Racing & Evolution Exhaust System

Akrapovic Racing & Evolution Exhaust System

for the Yamaha TT-R 125L (2000 -2005)

The Akrapovic RACING or EVOLUTION exhaust system will give the Yamaha 125 a more racy look and improved performance. The systems are designed for riders who can feel and take advantage of even minimal differences in the power and torque curves. Both systems are designed in order to satisfy both the European and American markets. For the European market, the system has a built-in noise damper, and for the American market it has an approved spark arrester.

PERFORMANCE

Measurements of the Akrapovic RACING system on the YAMAHA TT-R 125L (without muffler insert):

Power & Torque: the Akrapovic RACING (& EVOLUTION) system shows its advantages in keeping with its racing heritage: at the top of the rpm range and in the over-rev range, where the graph shows the maximum increased power. There is also an increase at the low end of the range. The torque curve shows similar increases.

CONFIGURATION

The configurations of the Akrapovic RACING and EVOLUTION systems for the TT-R 125 are identical. They differ only in the selection of materials. The Akrapovic RACING system is composed of a cylindrical stainless steel header tube, while EVOLUTION of titanium. Header tube for the Yamaha TT-R 125 also takes the role of collector and link pipe. The joint with the muffler is a sleeve joint held together with a silicon-shielded tensioning spring. The muffler is the offroad design with a titanium outer sleeve, and a titanium inlet and outlet cap and inner perforation. The muffler is attached to the bike using an Akrapovic road carbon-fiber clamp. The stock heat shield can be mounted on the header tube. For the European market, the system has a built-in noise damper, and for the American market it has an approved spark arrester.

	PERFORMANCE		
	stock	AKRAPOVIC	max. increased power
max. rear wheel power HP / rpm (measured on SuperFlow Cyle Dyn)	8.9 / 7260	9.4 / 7930	1.0 / 8320

	CONFIGURATION		
	header tubes	collector	link pipe
material	STAINLESS STEEL (Racing) TITANIUM (Evoluton)	-	STAINLESS STEEL (Racing) TITANIUM (Evoluton)
tube shape	CYLINDRICAL	-	CYLINDRICAL

interference crossover tubes	-	lambda sensor	-
header tube inner sleeves	S.S. CNC MACHINED	header tube flanges	ALU CNC MACHINED
header tubes - collector connection	-	collector / header tube - link pipe connection	SLEEVE JOINT + SILICON SHIELDED SPRINGS
link pipe - muffler connection	WELDED	muffler inlet cap /outlet cap	TITANIUM / TITANIUM
muffler metal interior	TITANIUM	muffler outer sleeve	TITANIUM
muffler clamp	CARBON-FIBER ROAD	muffler bracket	-
muffler insert	NOISE DAMPER (EU market) SPARK ARRESTER (US market)	heat shield	-

OPTIONS				
link pipe	noise damper	muffler outer sleeve	muffler bracket	heat shield
-	-	-	-	-

	ADDITIONAL DATA				
	stock	AKRAPOVIC		difference	
		RACING	EVOLUTION	stock - RACING	stock - EVOLUTION
weight comparison (kg)	2.88	2.42	2.19	0.46	0.69
noise measurements (dB / rpm)	stock		AKRAPOVIC		
	83.5 / 4000		86.9 / 4000		
possibility of periodic service without removing A.E.S.	oil		oil filter		
	YES		YES		
legal for street use	NO				

Technical specifications of Akrapovic exhaust systems and related products subject to change without notice.

Product code: Racing: 104334 (S-Y1MR1-MT), 104336 (S-Y1MR1-MTA) (US market)
Evolution: 104333 (S-Y1MET1-MT), 104335 (S-Y1MET1-MTA) (US market)

Akrapovic Racing & Evolution Exhaust System for the Yamaha TT-R 125L (2000 -2005)



CARBON-FIBER
MUFFLER CLAMP

Off-Road
Program

Product code: Racing: 104334 (S-Y1MR1-MT), 104336 (S-Y1MR1-MTA) (US market)
Evolution: 104333 (S-Y1MET1-MT), 104335 (S-Y1MET1-MTA) (US market)



Akrapovic Racing & Evolution Exhaust System for the Yamaha TT-R 125L (2000 -2005)



Off-Road
Program

Product code: Racing: 104334 (S-Y1MR1-MT), 104336 (S-Y1MR1-MTA) (US market)
Evolution: 104333 (S-Y1MET1-MT), 104335 (S-Y1MET1-MTA) (US market)



Akrapovic Racing & Evolution Exhaust System for the Yamaha TT-R 125L (2000 -2005)



Off-Road
Program

Product code: Racing: 104334 (S-Y1MR1-MT), 104336 (S-Y1MR1-MTA) (US market)
Evolution: 104333 (S-Y1MET1-MT), 104335 (S-Y1MET1-MTA) (US market)

Akrapovic Racing & Evolution Exhaust System for the Yamaha TT-R 125L (2000 -2005)

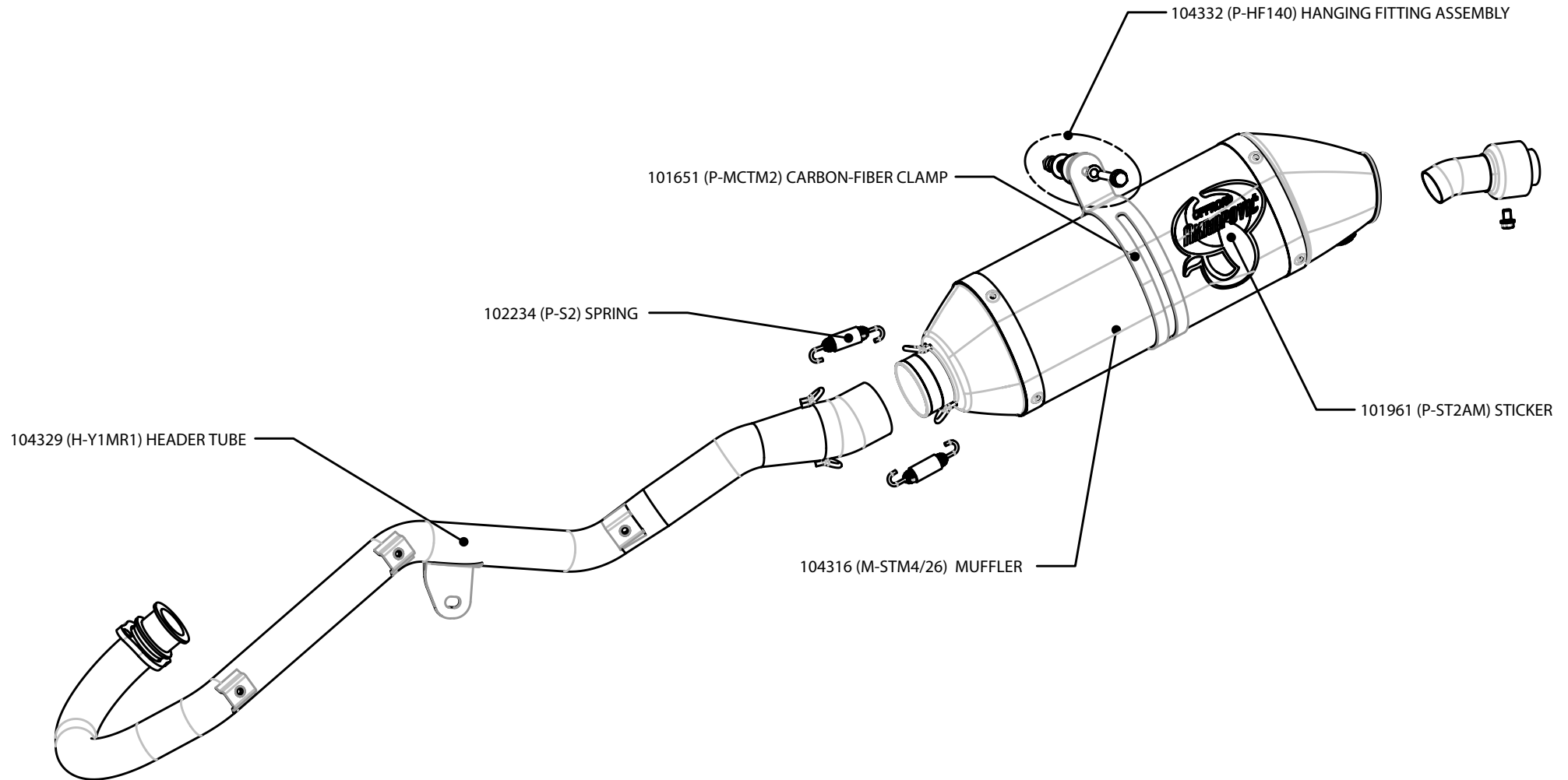

Akrapovic Exhaust System Technology copyright 2005, all rights reserved

Off-Road
Program

Product code: Racing: 104334 (S-Y1MR1-MT)

Akrapovic Racing & Evolution Exhaust System for the Yamaha TT-R 125L (2000 -2005)

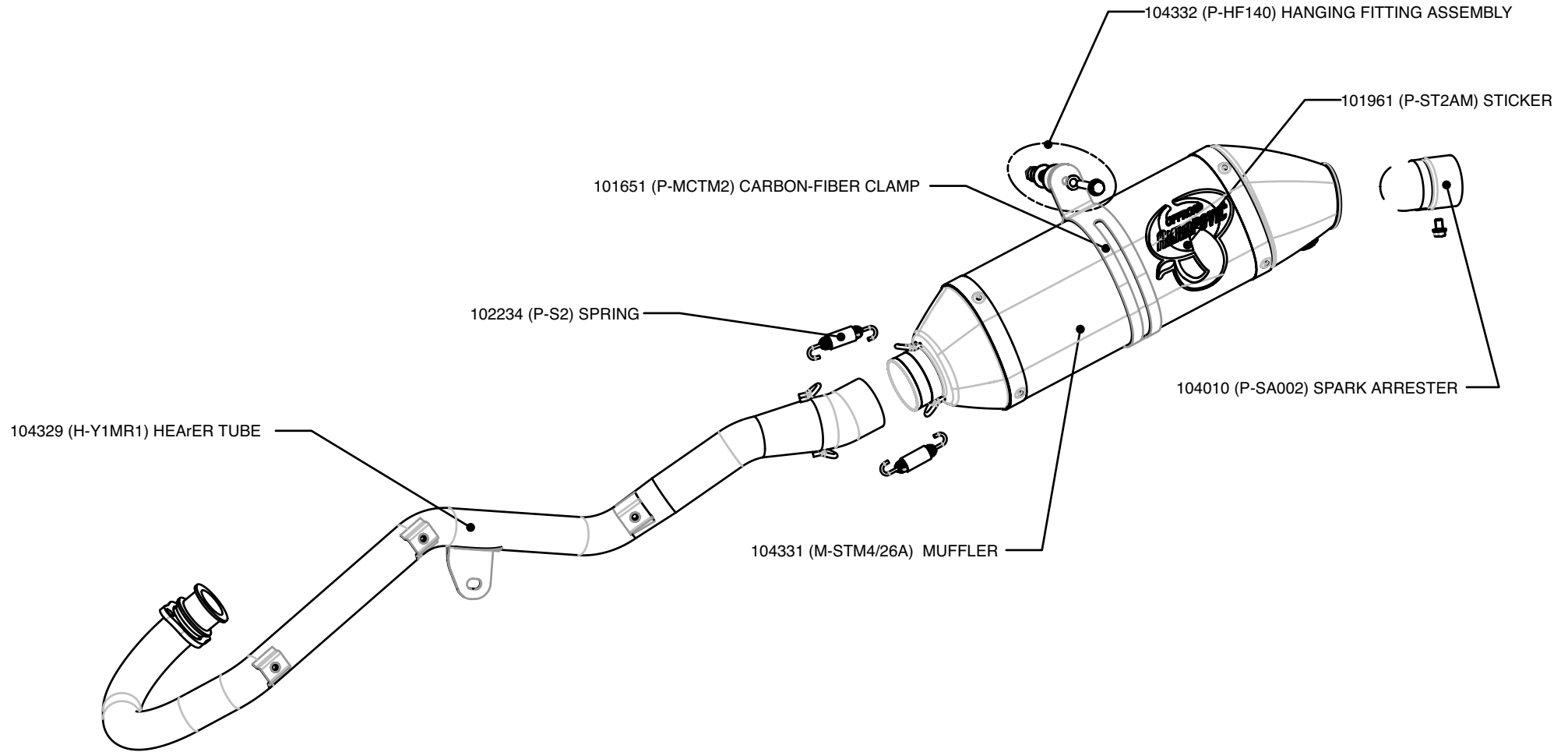

Akrapovic Exhaust System Technology 2005, all rights reserved

Off-Road
Program

Product code: Racing: 104336 (S-Y1MR1-MTA) (US market)

Akrapovic Racing & Evolution Exhaust System for the Yamaha TT-R 125L (2000 -2005)

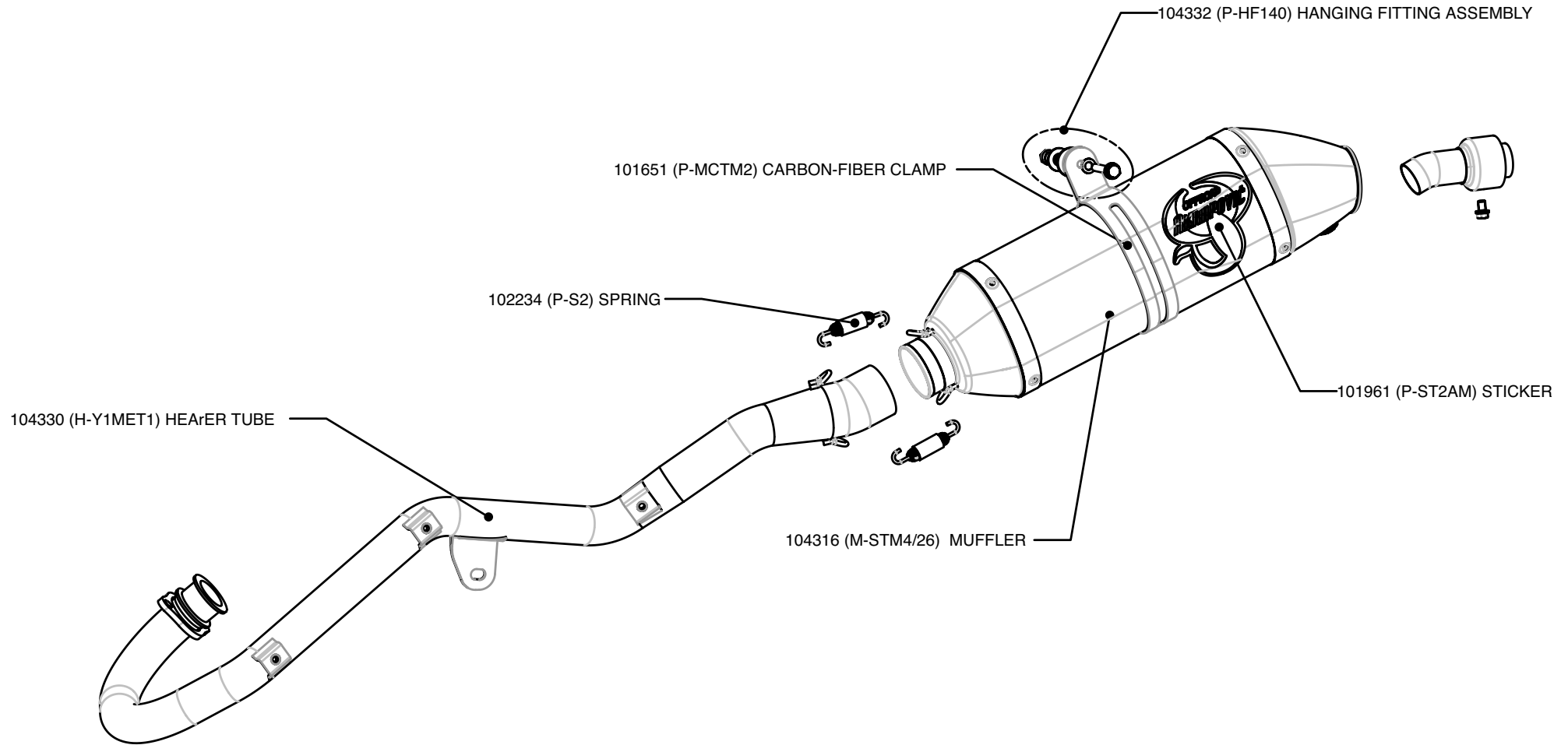

Akrapovic Exhaust System Technology copyright 2005, all rights reserved

Off-Road
Program

Product code: Evolution: 104333 (S-Y1MET1-MT)



Akrapovic Racing & Evolution Exhaust System for the Yamaha TT-R 125L (2000 -2005)

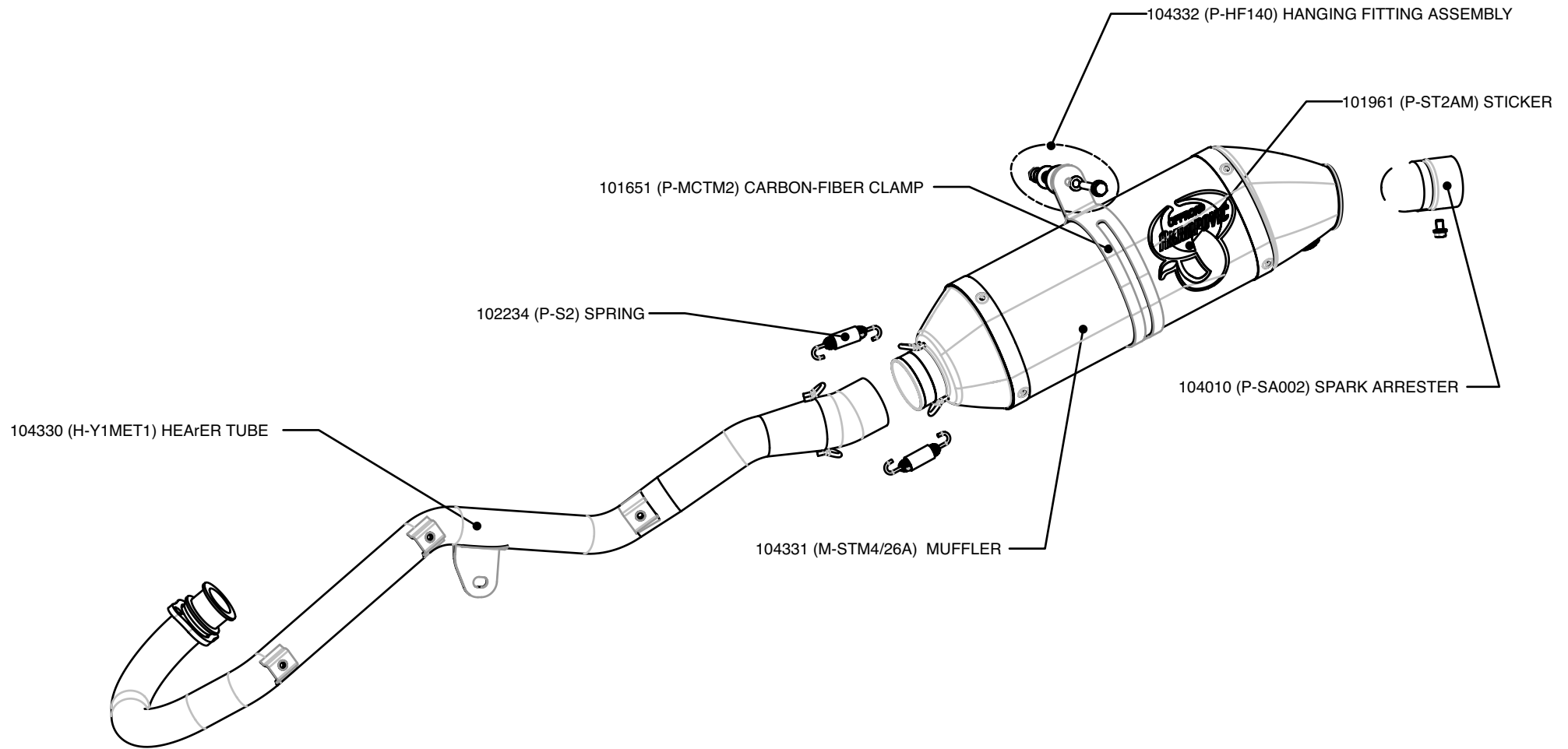

Akrapovic Exhaust System Technology 2005, all rights reserved

Off-Road
Program

Product code: Evolution: 104335 (S-Y1MET1-MTA) (US market)

Akrapovic Racing & Evolution Exhaust System

for the Yamaha TT-R 125L (2000 -2005)

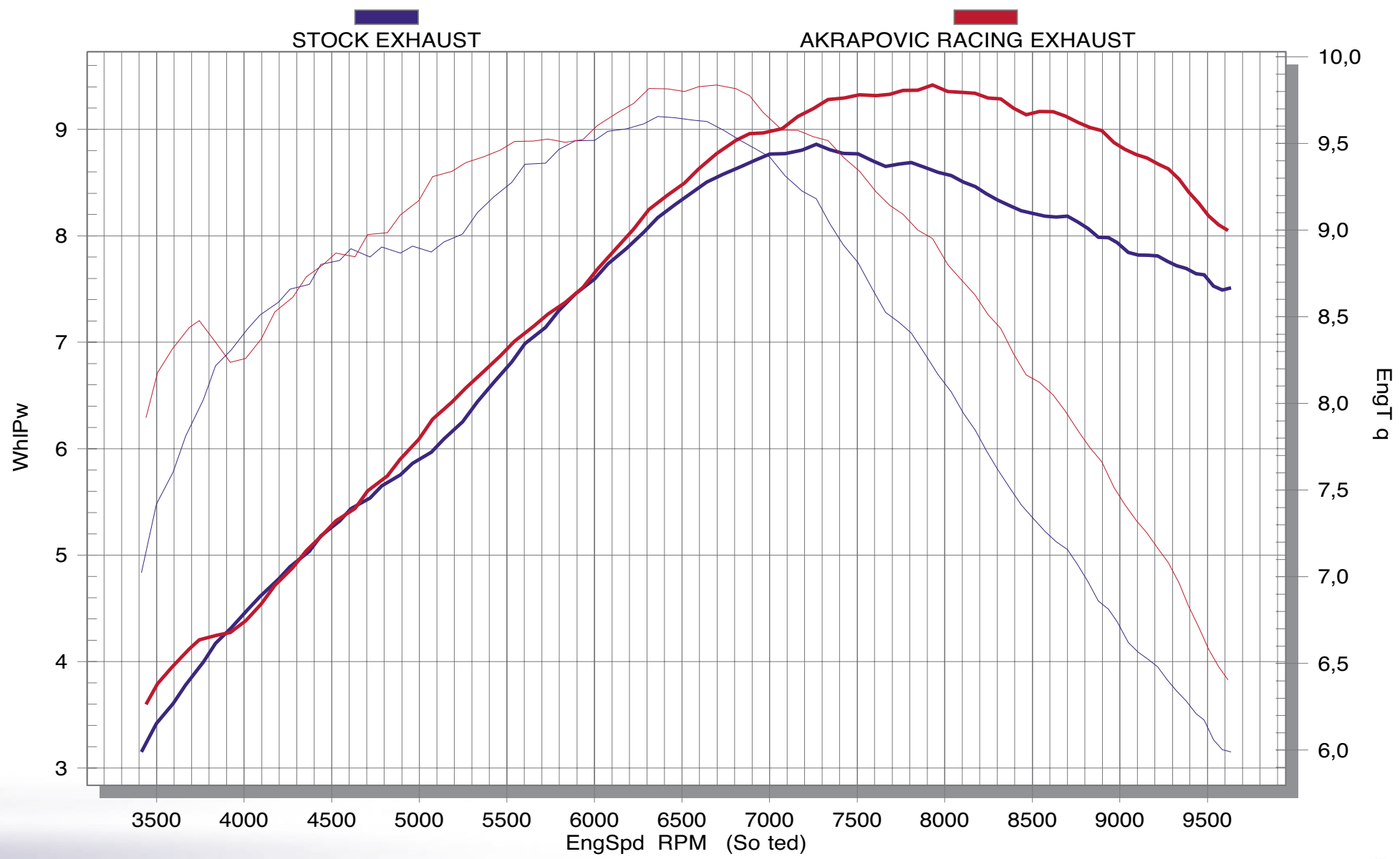

Off-Road Program

Product code: Racing: 104334 (S-Y1MR1-MT), 104336 (S-Y1MR1-MTA) (US market)
 Evolution: 104333 (S-Y1MET1-MT), 104335 (S-Y1MET1-MTA) (US market)



Akrapovic Exhaust System Technology copyright 2005, all rights reserved