



APRILIA RSV MILLE

(2007 - 2009)

EVOLUTION STREET LEGAL EXHAUST SYSTEM

www.akrapovic.com

The Akrapovic EVOLUTION street legal systems are designed for riders who attend trackdays and expect the maximum from their exhaust system and know how to take advantage of it. This exhaust systems comply strict exhaust gas and noise emission regulations. The Racing and Evolution street legal systems makes the Aprilia superbike substantially more responsive. Hexagonal mufflers also provides a great visual and sound modification.

PERFORMANCE

Measurements of the Akrapovic EVOLUTION street legal system on the APRILIA RSV MILLE (with muffler insert):

Power & Torque: the Akrapovic exhaust system increase the responsiveness of the Aprilia and fill out the power and torque curves. The increase in power and torque starts already at around 3000 rpm and leads all the way to the top of the rpm range. At 10300 rpm we measured a massive 129.1 HP on rear wheel and max. increase of power 9.4 HP at 10550 rpm.

CONFIGURATION

The Racing and Evolution systems differ only in the selection of tubing materials. The Racing is made of stainless steel, and the Evolution is made of titanium. Both systems have conical tubes, collectors, and a link pipe. All of the system components are attached with sleeve joints secured with silicon-shielded springs. The header tubes come with interference crossover tubes, and the systems also include a fitting for attaching a lambda sensor. The HEXAGONAL muffler is definitely the most eye-catching element of the system. It is made of a titanium inlet cap and perforated inner sleeve, while the outlet cap is made of carbon fiber. The outer sleeve is available in titanium or carbon fiber. The muffler is attached to the frame using an Akrapovic carbon fiber clamp.

	PERFORMANCE		
	stock	AKRAPOVIC	max. increased power
max. rear wheel power HP / rpm <small>(measured on Dynojet ATV)</small>	122.1 / 9740	129.1 / 10300	9.4 / 10550

	CONFIGURATION		
	header tubes	collector	link pipe
material	S.S. (begining) S.S. / TI (header tube)	S.S. / TI	STAINLESS STEEL / TITANIUM
tube shape	CONICAL	CONICAL	CONICAL

interference crossover tubes	YES (in collector)	lambda sensor	YES
header tube inner sleeves	-	header tube flanges	S.S LASER CUT
header tubes - collector connection	SLEEVE JOINT + SILICON SHIELDED SPRINGS	collector / header tube - link pipe connection	SLEEVE JOINT + SILICON SHIELDED SPRINGS
link pipe - muffler connection	SLEEVE JOINT + SILICON SHIELDED SPRINGS	muffler inlet cap /outlet cap	Ti / Carb.-fiber
muffler metal interior	TITANIUM	muffler outer sleeve	Ti / Carb.-fiber
muffler clamp	CARBON-FIBER	muffler bracket	Carb.-fiber (OPTIONAL)
muffler insert	EU	YES	heat shield
	US	-	YES (stock)
		catalytic converter	YES (2x)

	ADDITIONAL DATA				
	stock	AKRAPOVIC		difference	
weight comparison (kg)	12.57	S.S. link pipe	TITANIUM link pipe	stock - S.S.	stock - titanium
		-	5.52	-	7.05

noise measurements (dB / rpm)	stock	AKRAPOVIC
	94 / 4750	94 / 4750
possibility of periodic service without removing A.E.S.	oil	oil filter
	YES	YES
legal for street use	YES	

Technical specifications of Akrapovic exhaust systems and related products subject to change without notice.



Product code: S-A10E7TC-HRT (108262)
S-A10E7TC-HRC (108263)



www.akrapovic.com
Akrapovic d.d. 2009 all rights reserved
31.05.2009



Product code: S-A10E7TC-HRT (108262)
S-A10E7TC-HRC (108263)



Product code: S-A10E7TC-HRT (108262)
S-A10E7TC-HRC (108263)

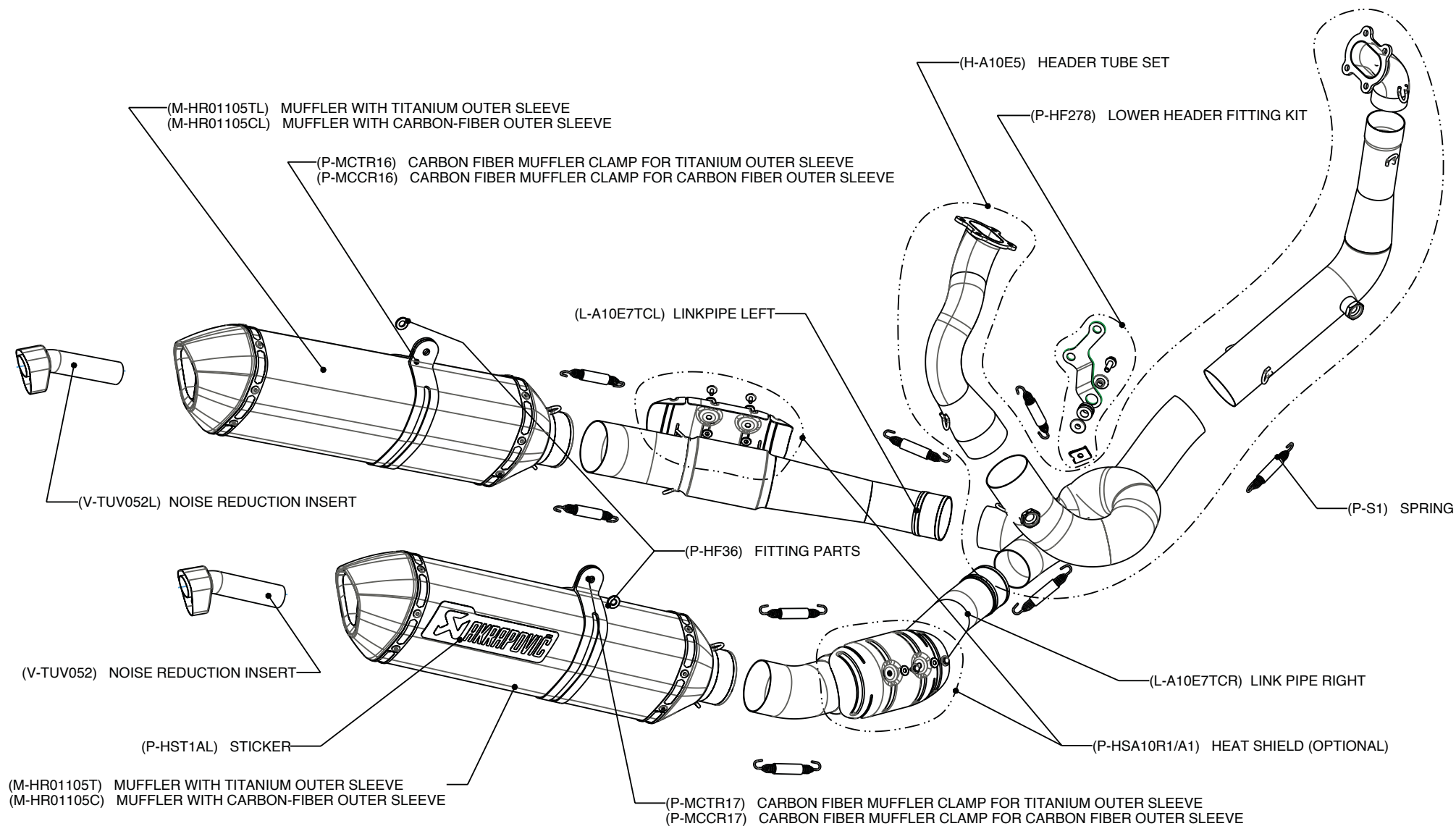

Product code: S-A10E7TC-HRT (108262)
S-A10E7TC-HRC (108263)



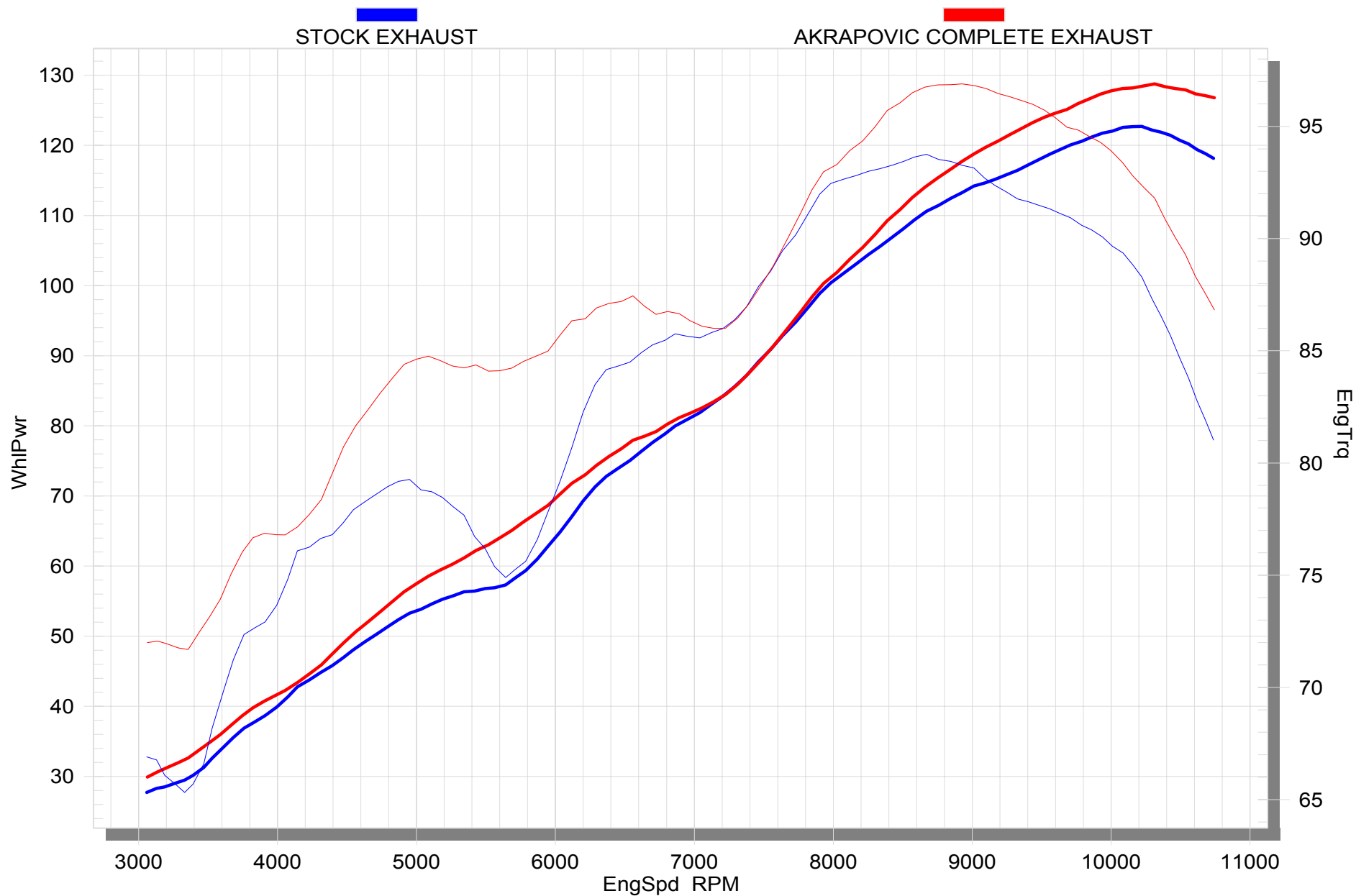

Product code: S-A10E7TC-HRT (108262)
S-A10E7TC-HRC (108263)

